

© This drawing and design are copyright.
 Do not scale from this drawing. Use only figured dimensions. If in doubt, ask.
 All dimensions are to be checked on site.
 Any discrepancies should be reported immediately to the Architect.

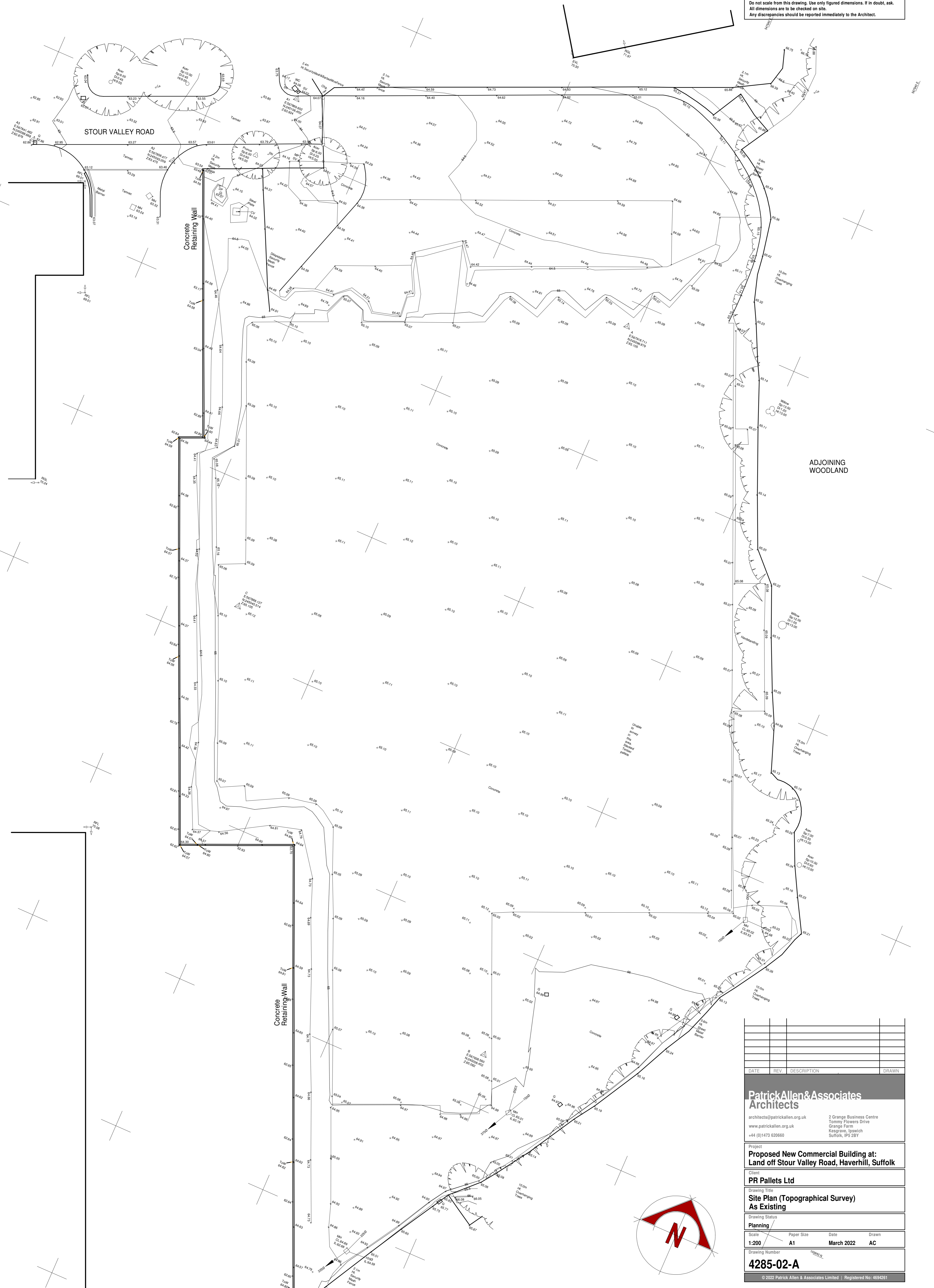

ADJOINING WOODLAND

DATE	REV	DESCRIPTION	DRAWN

Patrick Allen & Associates Architects
 architects@patrickallen.org.uk
 www.patrickallen.org.uk
 +44 (0)1473 620660

2 Grange Business Centre
 Tommy Flowers Drive
 Grange Farm
 Kesgrave, Ipswich
 Suffolk, IP5 2BY

Project
**Proposed New Commercial Building at:
 Land off Stour Valley Road, Haverhill, Suffolk**

Client
PR Pallets Ltd

Drawing Title
**Site Plan (Topographical Survey)
 As Existing**

Drawing Status
Planning

Scale	Paper Size	Date	Drawn
1:200	A1	March 2022	AC

Drawing Number
4285-02-A

© 2022 Patrick Allen & Associates Limited | Registered No: 4694261

