

Proposed Permeable Paving (1692m<sup>2</sup>)  
\*Subject to detailed design\*

# SUDS/POS/LEAP

# PHASE 6

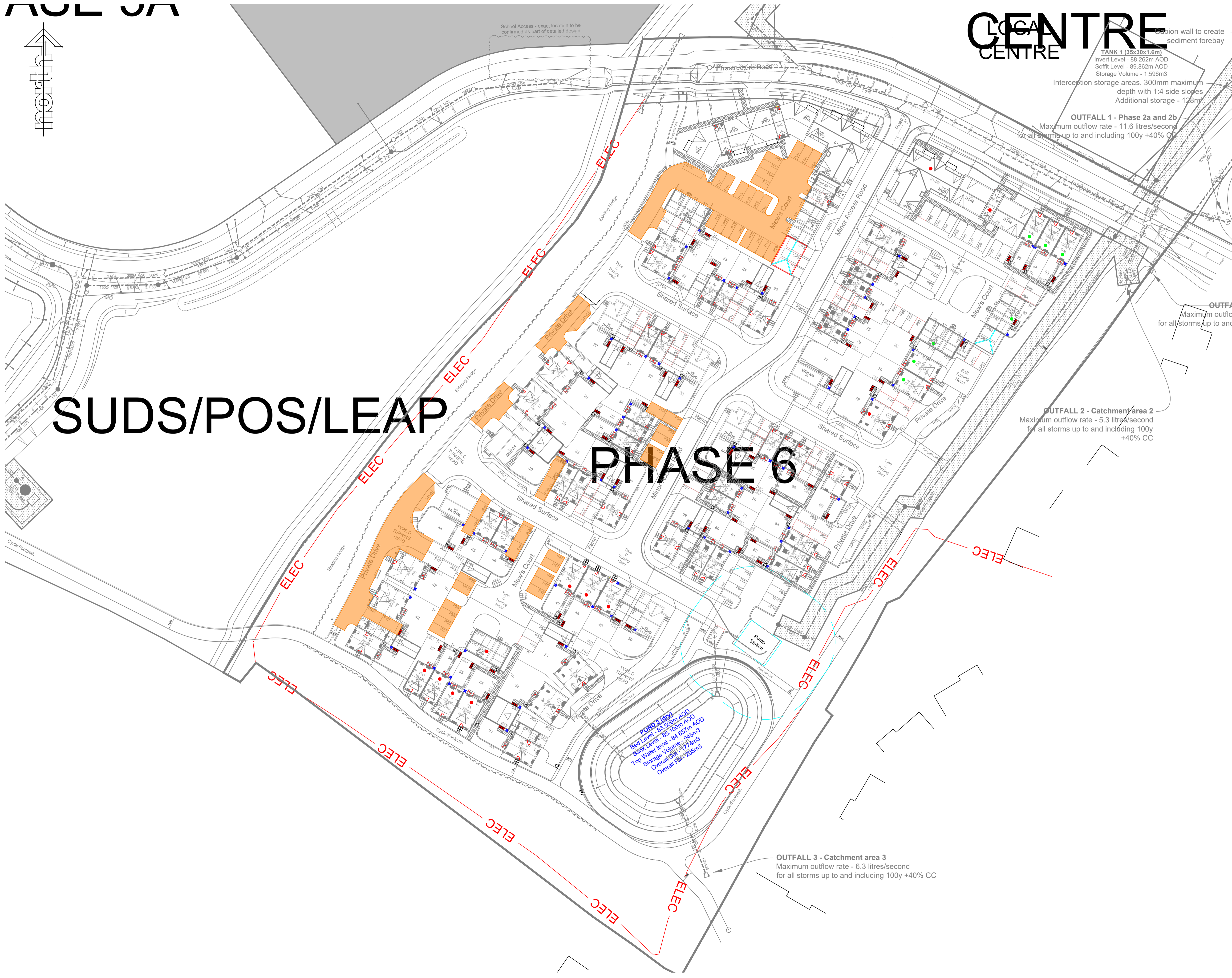

TANK 1 (35x30x1.6m)  
Invert Level - 88.262m AOD  
Soffit Level - 89.862m AOD  
Storage Volume - 1,596m<sup>3</sup>  
Interception storage areas, 300mm maximum depth with 1:4 side slopes  
Additional storage - 128m<sup>3</sup>

OUTFALL 1 - Phase 2a and 2b  
Maximum outflow rate - 11.6 litres/second  
for all storms up to and including 100y +40% CC

OUTFALL 2 - Catchment area 2  
Maximum outflow rate - 5.3 litres/second  
for all storms up to and including 100y +40% CC

OUTFALL 3 - Catchment area 3  
Maximum outflow rate - 6.3 litres/second  
for all storms up to and including 100y +40% CC

POND 2 (dry)  
Bed Level - 83.530m AOD  
Bank Level - 85.100m AOD  
Top Water Level - 84.657m AOD  
Storage Volume - 245m<sup>3</sup>  
Overall Size - 277m<sup>2</sup>

Rev	Description	By	Date
A	Updated to latest site layout	SB	30.03.22

**PERSIMMON**  
Persimmon Homes Ltd.  
Persimmon House  
Orion Court, Orion Avenue  
Great Blakenham  
Suffolk IP6 0LW  
Tel 01473 927400

Site Name:  
**Boyton Place, Ph6  
Haverhill  
Suffolk**

Drawing:  
**Additional SUDS Proposal**

Scale@A1: 1:500	Date: March 2022
Drawn By: SB	Checked By:
Drawing No: <b>049-E-SK40</b>	Rev: A