

© THIS DRAWING AND THE DETAILS DEPICTED ARE THE COPYRIGHT OF BSP CONSULTING AND MAY NOT BE REPRODUCED EXCEPT BY WRITTEN PERMISSION. OS LICENCE NO. 10004172

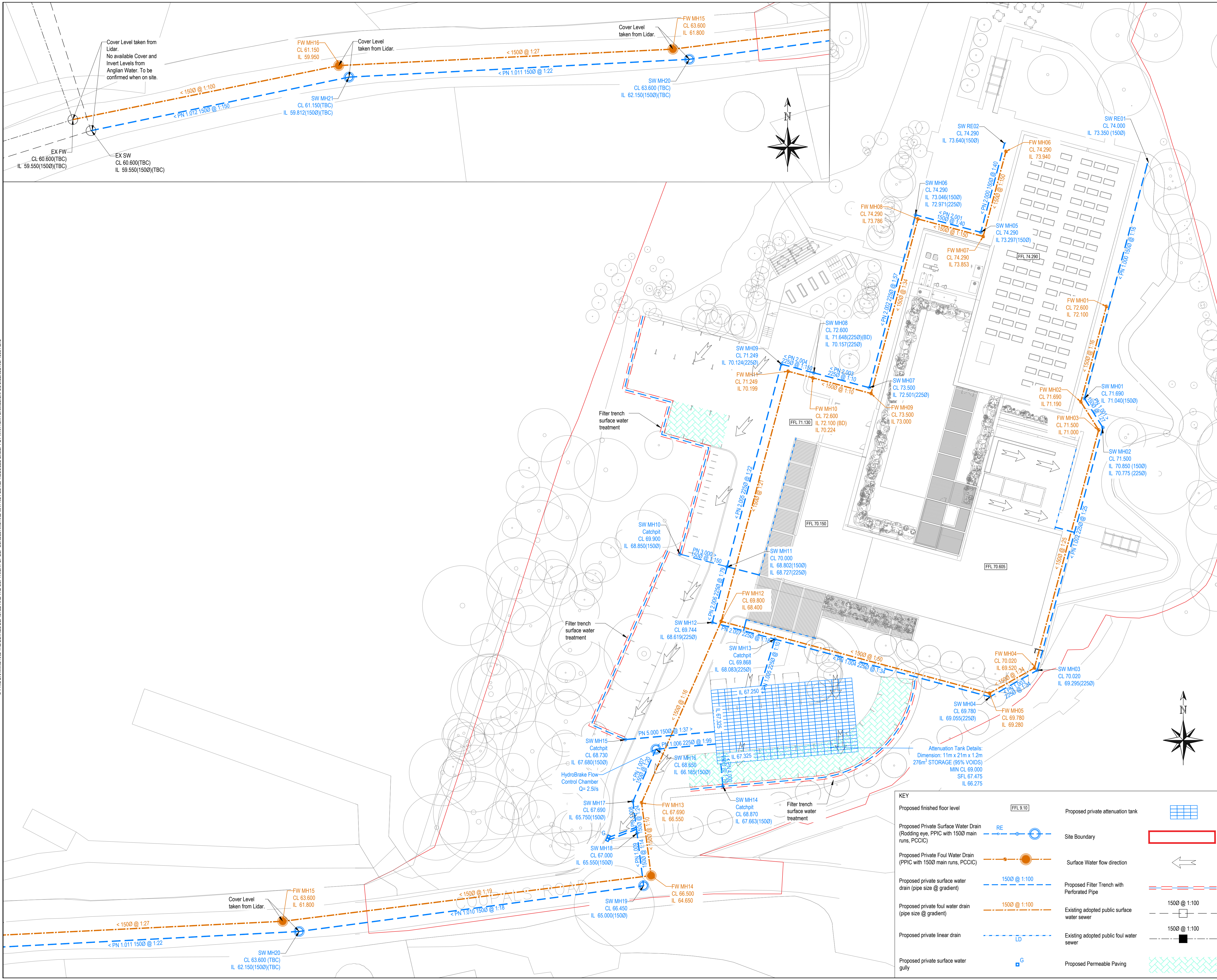

KEY PLAN		
Construction Risks	Maintenance/Cleaning Risks	Demolition/Adaptation Risks
In addition to the hazards/risks normally associated with the type of works detailed on this drawing take note of the above. It is assumed that all works on this drawing will be carried out by a competent contractor working, where appropriate, to an appropriate method statement.		
SAFETY HEALTH AND ENVIRONMENTAL INFORMATION BOX		
NOTES		
1. DO NOT SCALE.		
2. Should there be any conflict between the details indicated on this drawing and those indicated on other drawings the Engineer should be informed PRIOR to construction on site.		
3. Until technical approval has been obtained from the relevant Authority, it should be understood that all drawings issued are Preliminary and NOT for construction. Should the contractor commence site work prior to such approval being given, it is entirely at his own risk.		
4. All dimensions are in millimetres unless otherwise stated.		
5. The BSP Hazard Identification and Risk Assessment information for this project must be reviewed and understood by the contractor PRIOR to the commencement of any works on site.		
6. This drawing contains the following model files:		
7. This drawing to be viewed in conjunction with:		
Amendments to address LLFA comments		
P06	FE	30/01/24
Amendments due to LLFA comments		
P05	FE	18/12/23
New Site Layout		
P04	FE	08/12/23
New Site Layout		
P03	FE	10/11/23
Updated Site Boundary		
P02	FE	08/11/23
First Issue		
P01	FE	30/10/23
REV	COMMENT	DATE
DRAWN BY	DATE	CHECKED BY
SCALE @ A1	ISSUING OFFICE	PROJECT NUMBER
1:250	NOTTINGHAM	22-0364
CLIENT APPROVAL		
A - APPROVED		
B - APPROVED WITH COMMENTS		
C - DO NOT USE		
STATUS	PURPOSE OF ISSUE	
S1	PRELIMINARY	
<ul style="list-style-type: none"> <li>CIVIL</li> <li>STRUCTURAL</li> <li>TRANSPORTATION</li> <li>GEOTECHNICAL</li> <li>ENVIRONMENTAL</li> </ul>		
12 Oxford Street Nottingham, NG1 5BG Tel: 01454 413400 e-mail: info@bsp-consulting.co.uk Also offices in Derby, Leicester and Sheffield		
PROJECT		
Former Woodlands Hotel, Coupals Road, Haverhill		
TITLE		
Drainage Strategy		
CLIENT		
Country Court Care Homes		
PROJECT ORIGINATOR	FUNCTIONAL	SPATIAL
FORM	DISCIPLINE	NUMBER
WHCH-BSP-ZZ-XX-D-C-0240		P06

Proposed finished floor level	FFL 9.10	Proposed private attenuation tank	
Proposed Private Surface Water Drain (Rodding eye, PPIC with 1500 main runs, PCCIC)	RE	Site Boundary	
Proposed Private Foul Water Drain (PPIC with 1500 main runs, PCCIC)		Surface Water flow direction	
Proposed private surface water drain (pipe size @ gradient)	1500 @ 1:100	Proposed Filter Trench with Perforated Pipe	
Proposed private foul water drain (pipe size @ gradient)	1500 @ 1:100	Existing adopted public surface water sewer	
Proposed private linear drain	LD	Existing adopted public foul water sewer	
Proposed private surface water gully	G	Proposed Permeable Paving	

Attenuation Tank Details:  
 Dimension: 11m x 21m x 1.2m  
 276m<sup>3</sup> STORAGE (85% VOIDS)  
 MIN CL 69.000  
 SFL 67.475  
 IL 66.275