

PROPOSED.

DRYLINE WALLS:- Dryline walls with 1200 gauge membrane backing to wall with 100mm x 50mm stress graded studs at 600mm cts to incorporate 100mm celotex GA 4000 between and 50mm celotex TB4800 over 12.5mm plasterboard and skim finish.

Ensure 50mm air gap remains on top of 120mm celotex between rafters, 50mm celotex under 12.5mm plasterboard.

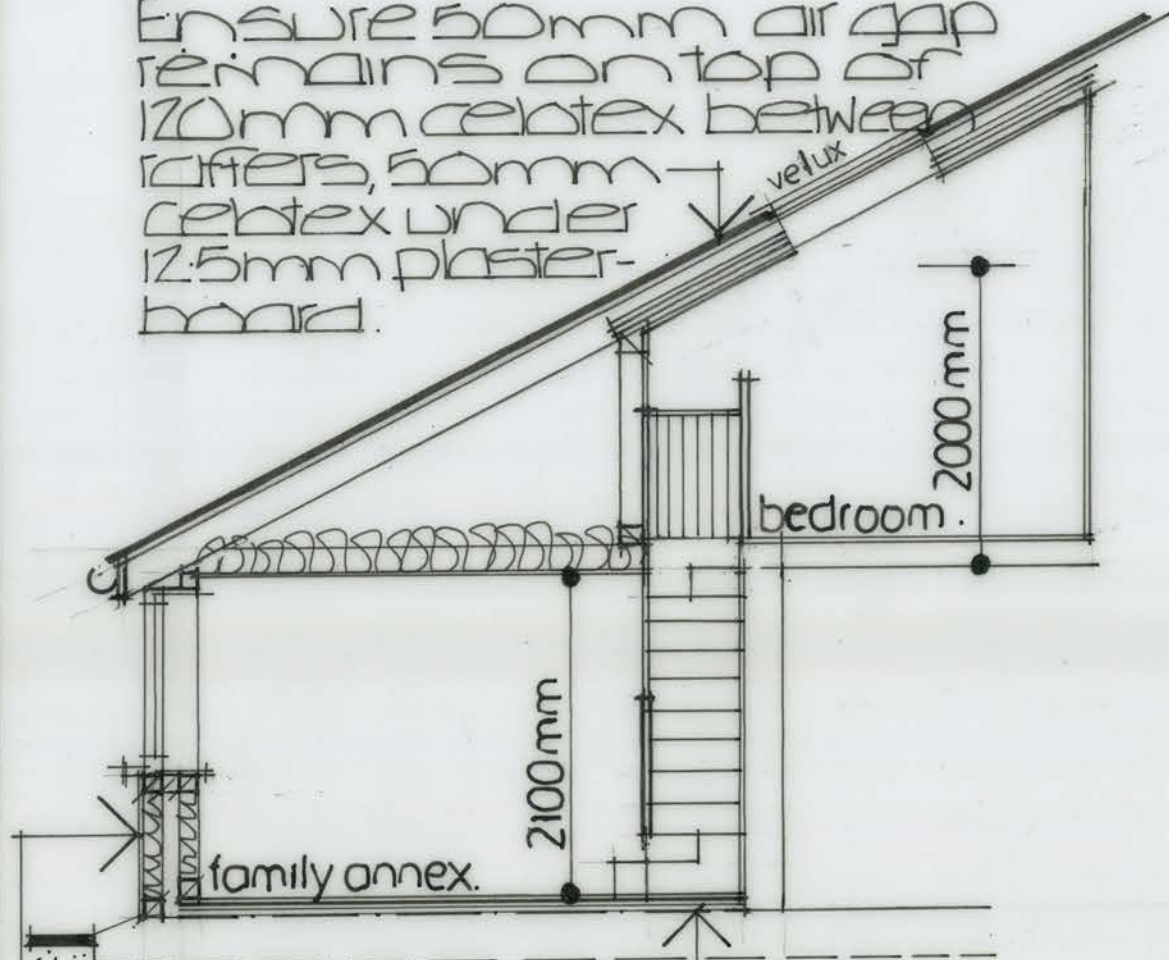

section .1:50.

Floating floor of 22mm ttg moisture resistant chipboard on 100mm celotex insulation on 1200 gauge damp proof membrane.

Hardi plank cladding of 50mm x 25mm battens on breathable membrane on 12.5mm W.B.P plywood clad internally and externally. 100mm x 50mm stress graded studs at 600mm cts centres clad internal with 100mm celotex insulation.

WINDOWS / DOORS + GLAZING:- All glazing to critical areas to be toughened. Double glazed sealed units constructed from 'K' glass with 20mm air gap. New frames are to be set back 30mm into the cavity. New windows are to achieve a 'U' value of 1.2 W/m K² and doors to achieve 'U' value of 1.4 W/m K². All fire escape windows i.e. to have a clear opening of 450mm x 850mm with cill max 1100mm above finished floor level.

ELECTRICS:- All electrical work to be undertaken by electrical contractor to satisfy Part P of the building regulations and provide the homeowner with completion certificate. 100% of energy efficient light fittings to be fitted. Ensure all electrical sockets and switches are fitted between 450mm and 1200mm above finished floor level.

STUDWALLS:- 100mm x 50mm timber studs "stress graded" at 600mm cts clad both sides with 12.5mm plasterboard and plaster skim. Incorporate 50mm Rockwool flexi acoustic mineral wool quilt. Studwalls to be of 40db rating.

NOTE. Builder to check all setting out details on site.

N.H BUILDING DESIGN.
18 PLASSET DRIVE, ATTLEBOROUGH, NORFOLK,
NR17 2NU. Tel: 01953-455715.

CLIENT.
12 Sandpiper Close, Haverhill.

SCALE.
1:50.

DATE.
JULY 2024.

DRAWING NO.
NH/24/25/3.