

REFER TO EA_1868_P_215 FOR CONTINUATION

REFER TO EA_1868_P_217 FOR CONTINUATION

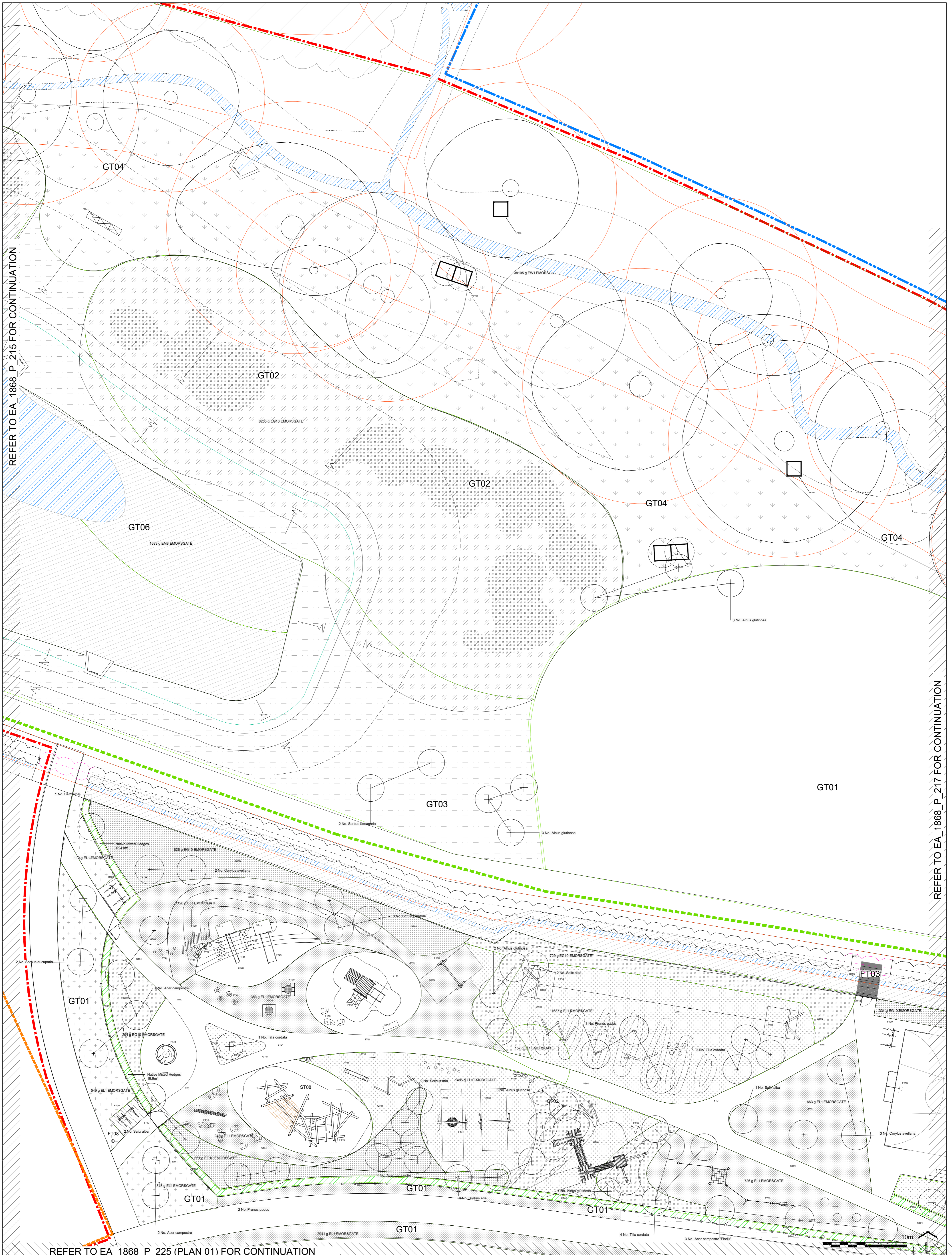

REFER TO EA_1868_P_225 (PLAN 01) FOR CONTINUATION

| | | | | | | |
|---|--|---|--|---|---|--------------------------|
| <p>EXTERIOR ARCHITECTURE</p> <p>LONDON: Studio 1S, Hewlett House, Havelock Terrace, London, SW8 4AS MANCHESTER: Studio 537, The Royal Exchange, St Anns Square, Manchester, M2 7DH</p> <p>E-Mail: office@exteriorarchitecture.com Web: www.exteriorarchitecture.com</p> | <p>Client REDROW LTD</p> | <p>Note: Please refer to drawing 1868_P_201 For planting schedule and key</p> | <p>Project title GREAT WILSEY PARK, HAVERHILL</p> | <p>Issued By: London Scale: 1:200 @ A1 Status: PLANNING Date: 26.03.2019</p> | <p>T: 020 7978 2101 Drawn: KL Checked: RP Approved: LP</p> | |
| | <p>No dimensions are to be scaled from this drawing. All dimensions are to be checked on site. Area measurements for indicative purposes only.</p> | <p>Rev</p> | <p>Date</p> | <p>Drawing title PLANTING PLAN 15 OF 25</p> | <p>Drawing number ExA_1868_P_216</p> | <p>Revision ----</p> |
| | <p>This drawing is the property of Exterior Architecture Ltd. No part of the drawing may be reproduced in any manner without permission from Exterior Architecture Ltd.</p> | <p>-----</p> | <p>-----</p> | <p>-----</p> | <p>-----</p> | <p>-----</p> |

P:\LONDON PROJECTS\2018181868_GREAT WILSEY PARK, HAVERHILL\01 CAD\02 SHEET LAYOUT\EXA_1868_P_216 PLANTING PLAN 15 OF 25.DWG