

DO NOT SCALE

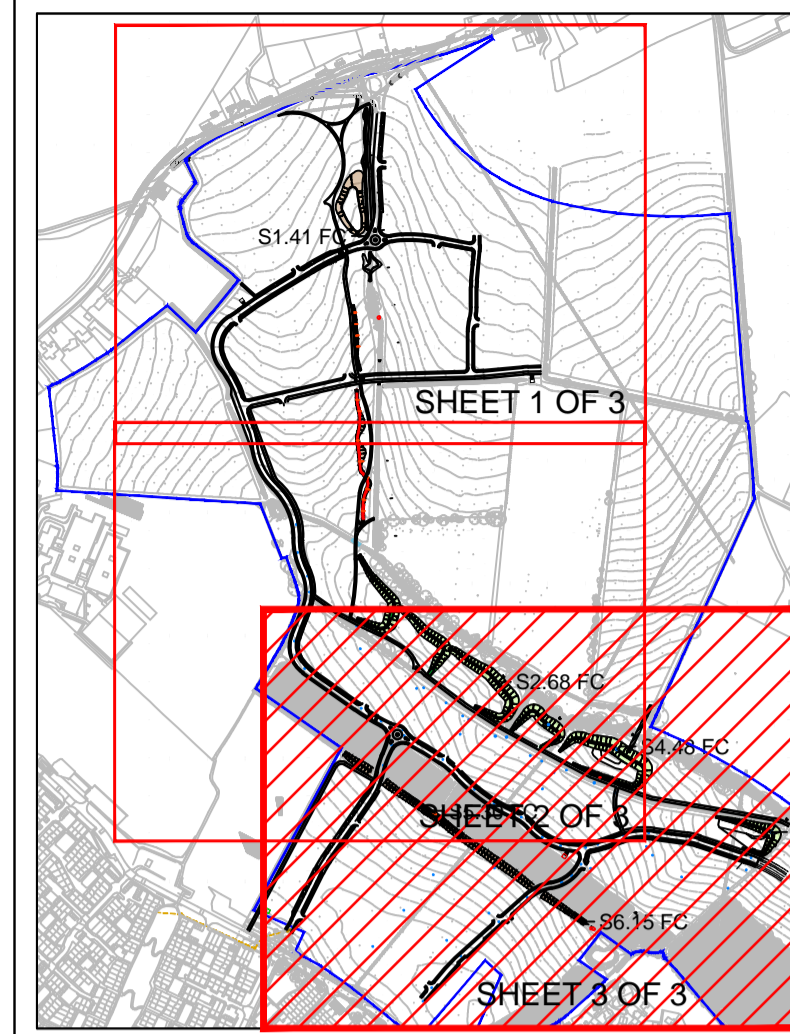
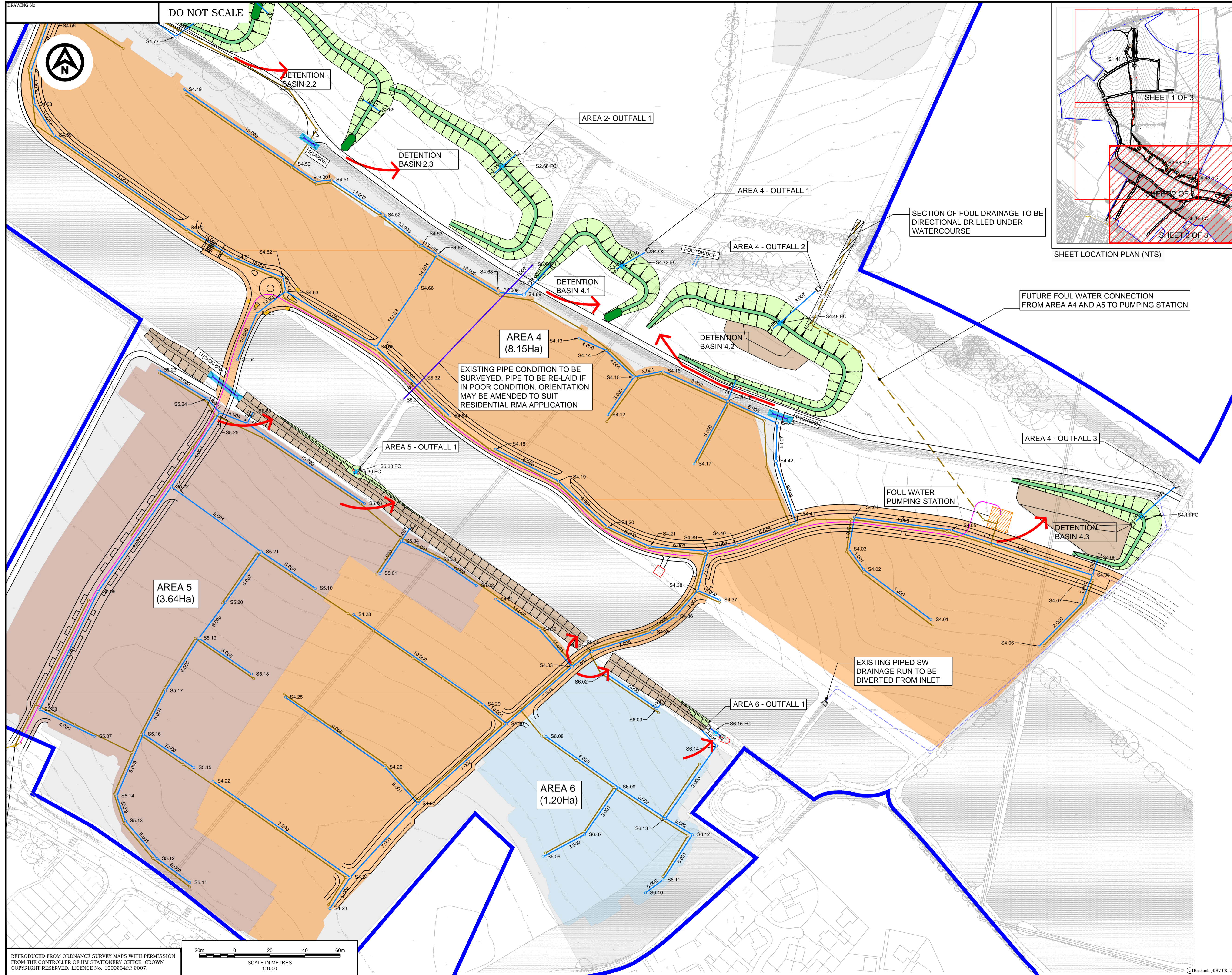

- GENERAL NOTES**
- DO NOT SCALE FROM THIS DRAWING.
 - ALL DIMENSIONS ARE IN METRES UNLESS NOTED OTHERWISE.
 - ALL LEVELS ARE IN METRES RELATIVE TO ORDNANCE DATUM UNLESS NOTED OTHERWISE.
 - THIS DRAWING HAS BEEN BASED UPON SURVEY / OS INFORMATION SUPPLIED BY OTHERS. ROYAL HASKONING DHV SHALL NOT BE LIABLE FOR ANY INACCURACY OR DEFICIENCIES ARISING FROM IT.
 - THIS DRAWING IS TO BE READ IN CONJUNCTION WITH ALL OTHER RELEVANT DRAWINGS.
 - ALL MATERIALS AND WORKMANSHIP WILL BE AS SPECIFIED IN THE SPECIFICATION UNLESS NOTED OTHERWISE.
 - ALL LEVELS, DIMENSIONS AND LOCATIONS ARE TO BE CHECKED BY THE MAIN CONTRACTOR PRIOR TO COMMENCEMENT OF ANY WORK ON SITE.

- KEY:**
- PROPOSED SURFACE WATER SEWER
 - EXTERNAL SURFACE WATER TO BE DIVERTED
 - PROPOSED FOUL WATER SEWER
 - PROPOSED FOUL WATER SEWER TO BE LAID AS PART OF THE S278 AGREEMENT
 - SITE BOUNDARY
 - PROPOSED DRY SWALE
 - PROPOSED PIPED CROSSING
 - PROPOSED RISING MAIN
 - PROPOSED FLOW CONTROL MANHOLE
 - LIST OF FLOW CONTROL DEVICES (REFER TO TABLE 1 ON SERIES OF DRAWINGS PB8301-RHD-DE-H1-DR-D-0600-607)

- AREA 1. OUTFALL 1.**
 FC01-01 Hydrobrake @ 5/s 150mm Above invert
 FC01-02 Ø225mm pipe 930mm Above invert
- AREA 2. OUTFALL 1.**
 FC02-01 Ø80mm plate 0mm Above invert
 FC02-02 Ø180mm plate 1200mm Above invert
- AREA 4. OUTFALL 1.**
 FC04-01 Hydrobrake @ 2/s 0mm Above invert
 FC04-02 Ø100mm pipe 750mm Above invert
- AREA 4. OUTFALL 2.**
 FC04-03 Hydrobrake @ 5/s 0mm Above invert
 FC04-04 Ø100mm pipe 1000mm Above invert
- AREA 4. OUTFALL 3.**
 FC04-05 Hydrobrake @ 2/s 0mm Above invert
 FC04-06 Ø100mm pipe 900mm Above invert
- AREA 5. OUTFALL 1.**
 FC05-01 Ø60mm plate 150mm Above invert
 FC05-02 Ø60mm plate 700mm Above invert
- AREA 6. OUTFALL 1.**
 FC06-01 Hydrobrake @ 1.2/s 150mm Above invert
 FC06-02 Ø55mm plate 800mm Above Invert
- PROPOSED LOG WALL WITH ORIFICE PLATE RESTRICTION
- PROPOSED INTERCEPTION DEPRESSION
- PROPOSED MAINTENANCE ACCESS
 EXACT ROUTE TO BE CONFIRMED WITH THE RESIDENTIAL RESERVED MATTERS APPLICATION
- SECTION OF FOUL SEWER TO BE DIRECTIONAL DRILLED UNDER WATERCOURSE
- OVERFLOW WEIR

101	20/03/19	FIRST ISSUE	JBW	PV	DJ
REV	DATE	DESCRIPTION	BY	CHK	APP

DRAWING STATUS INFORMATION

CLIENT

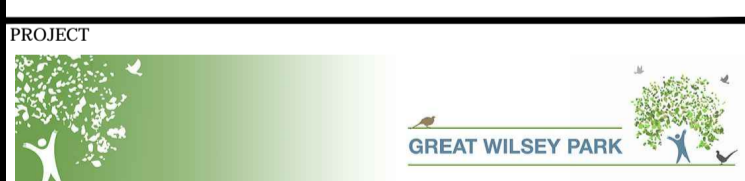

RESERVED MATTERS DRAINAGE NETWORK SHEET 3 OF 3



DRAWN	CHECKED	APPROVED
JBW	PV	DJ
DATE	SCALE AT A1	PROJECT NUMBER
MAR-19	1:1000	PB8301

DRAWING No.	REVISION
PB8301-RHD-DE-H1-DR-D-0503	101

REPRODUCED FROM ORDNANCE SURVEY MAPS WITH PERMISSION FROM THE CONTROLLER OF HM STATIONERY OFFICE. CROWN COPYRIGHT RESERVED. LICENCE No. 100023422 2007.

