

REFER TO EA\_1868\_P\_213 FOR CONTINUATION

REFER TO EA\_1868\_P\_215 FOR CONTINUATION

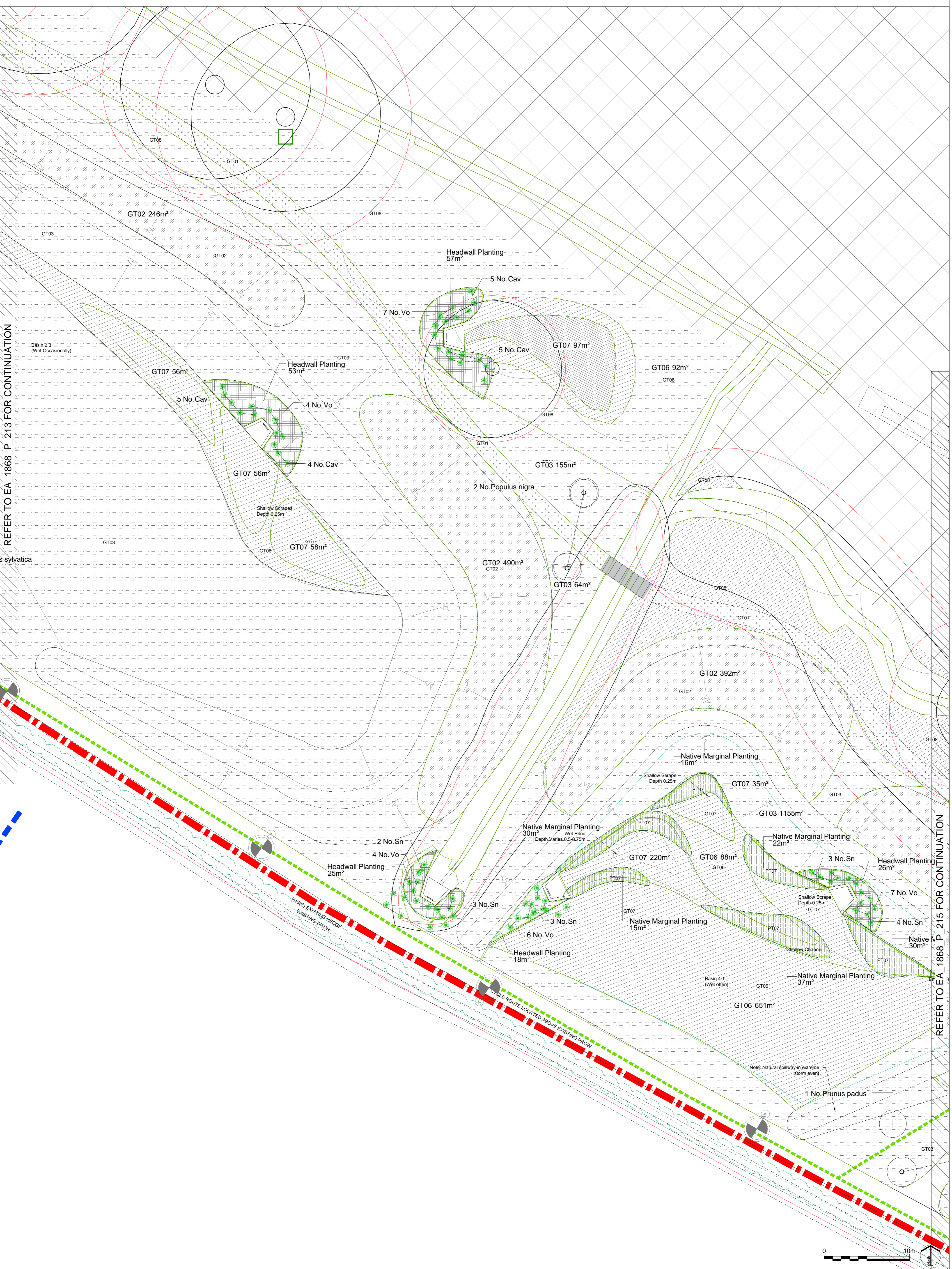

**EXTERIOR ARCHITECTURE**

LONDON: Studio 1S, Hewlett House, Havelock Terrace, London, SW8 4AS  
 MANCHESTER: Studio 537, The Royal Exchange, St Anns Square, Manchester, M2 7DH  
 E-Mail: office@exteriorarchitecture.com  
 Web: www.exteriorarchitecture.com

Client  
**REDROW LTD**

No dimensions are to be scaled from this drawing. All dimensions are to be checked on site. Area measurements for indicative purposes only.  
 This drawing is the property of Exterior Architecture Ltd. No part of the drawing may be reproduced in any manner without permission from Exterior Architecture Ltd.

Note: Please refer to drawing 1868\_P\_201 For planting schedule and key

Rev	Description	Date
D	Council comments	09.12.2019
C	Landowner Comments	02.08.2019
B	Clients Comments	12.07.2019
A	Planner's comments	05.07.2019
Rev	Description	Date

Project title  
**GREAT WILSEY PARK, HAVERHILL**

Drawing title  
**PLANTING PLAN 13 OF 25**

Issued By London  
 Scale 1:200 @ A1  
 Status **PLANNING**  
 Date 26.03.2019

Drawing number  
**ExA\_1868\_P\_214**

T: 020 7978 2101  
 Drawn SC  
 Checked RP  
 Approved LP

Revision  
**D**

P:\LONDON PROJECTS\2018\1868\_GREAT WILSEY PARK, HAVERHILL\01 CAD\02 SHEET LAYOUT\EA\_1868\_P\_214 PLANTING PLAN 13 OF 25.DWG