

**SITE LOCATION PLAN 1:1250**

LICENSE NUMBER 01172094

© Crown Copyright and database rights 2017 OS 100035409  
 Reproduction in whole or in part is prohibited  
 without the prior permission of Ordnance Survey

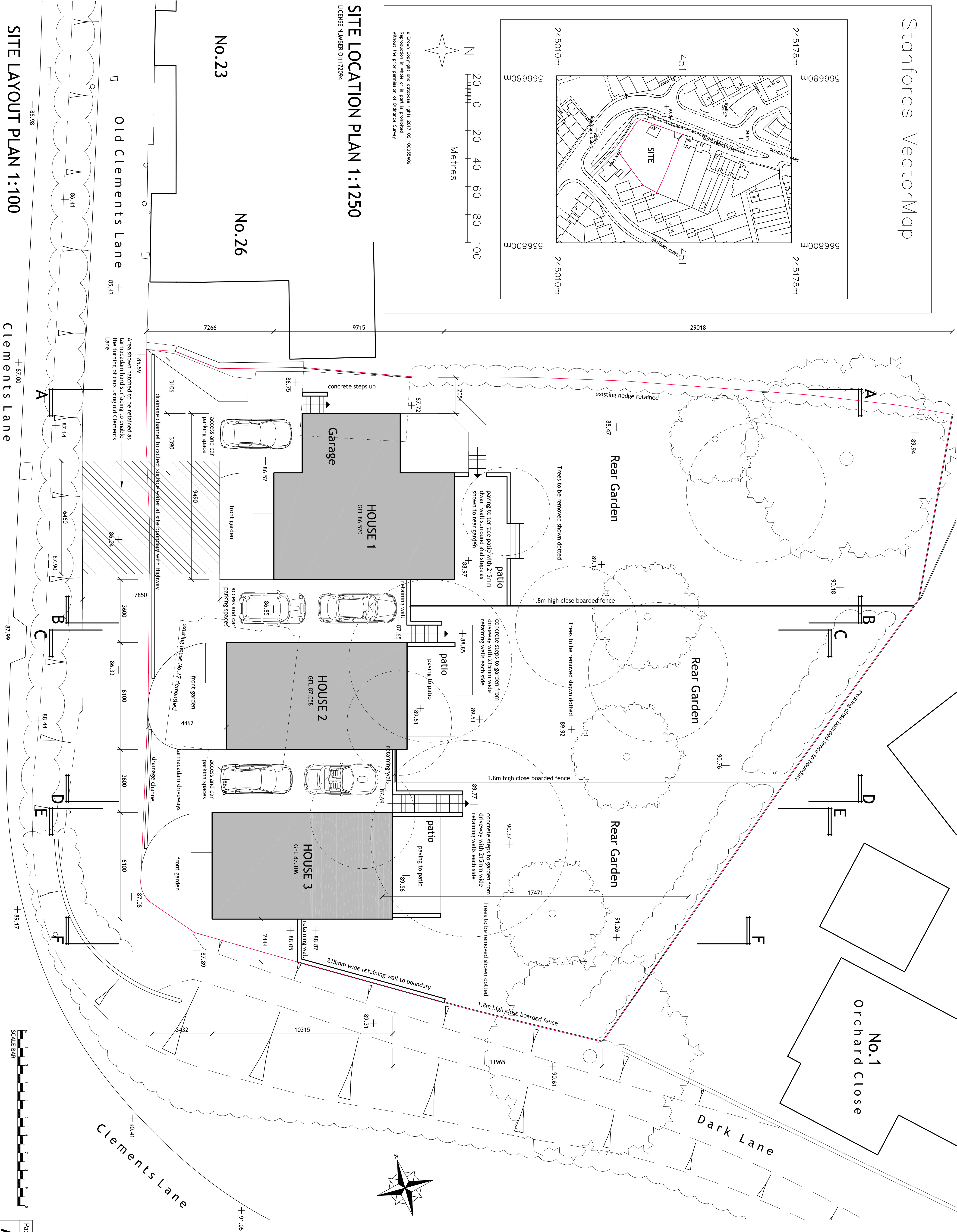

**SITE LAYOUT PLAN 1:100**

Clements Lane

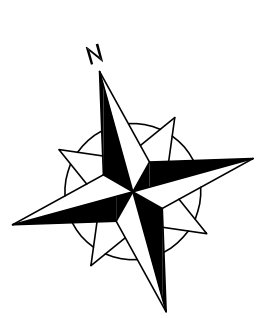
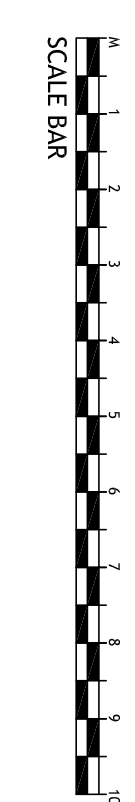

**General Notes:**

Do not scale from these drawings. The Contractor is responsible for checking all dimensions on site prior to commencement of the works with any errors being reported to Neil Cutforth & Associates as soon as possible. Any construction work carried out prior to receiving all necessary approvals is entirely at the householders / clients risk.

All building work to be carried out to the satisfaction of the Local Authority Building Control Officer and in accordance with the current Building Regulations and as such additional unforeseen building works may be required on site.

The Contractor shall inspect all adjoining properties which may be affected by the works prior to commencement or works and record and report with the owner any defects.

The Contractor shall be entirely responsible for the security, strength and stability of the building during the course of the works.

Drawings produced for the purpose of obtaining Building Regulations approvals only and do not constitute full working drawings.

All drawings are the copyright of Neil Cutforth & Associates. This drawing may not be copied by any third parties without prior permission.

**Notes:**

Rev	Description	Date	By
REVISIONS			

**Neil Cutforth & Associates**

Architectural Consultants

1A CENTURY PARK, LYNN ROAD, CHETTISHAM,  
 ELY, CAMBRIDGESHIRE, CB8 1SA  
 Tel: 01353 661212 Fax: 01353 661212  
 Email: [neil@neilcutforth.co.uk](mailto:neil@neilcutforth.co.uk)

Architectural Services - Local Authority Approval - Project Management  
 Extensions - Loft Conversions - Flat Conversions - Housing Developments

**Project**  
 PROPOSED HOUSING DEVELOPMENT  
 27 OLD CLEMENTS LANE, HAVERRILL

**Client**  
 MRS SUSAN FRANKS

**Drawing Title**  
 SITE PLANS PROPOSED

**Drawing Status**  
 PLANNING

Paper Size	Date	Drawn	Rev
A1	SEPT '19	NMC	826/17/01C