

Historical Mapping Legends

Ordnance Survey County Series and Ordnance Survey Plan 1:2,500

Quarry **Gravel Pit** **Sand Pit**
Clay Pit **Shingle** **Refuse Heap**
Sloping Masonry **Flat Rock**
Marsh **Reeds** **Osiers**
Rough Pasture **Furze** **Wood**
Mixed Wood **Brushwood** **Orchard**
Fir **Ford** **Stepping Stones**
Ferry **Waterfall** **Lock**
Trig. Station **Altitude at Trig. Station**
B.M. 325.9 **Bench Mark** **Surface Level**
Arrow denotes flow of water **Antiquities (site of)**
Cutting **Embankment**
Railway crossing Road **Level Crossing** **Road crossing Railway**
Railway crossing River or Canal **Road over single stream** **Road over River or Canal**
County Boundary (Geographical)
County & Civil Parish Boundary
Administrative County & Civil Parish Boundary
County Borough Boundary (England)
County Burgh Boundary (Scotland)
Co. Boro. Bdy.
Co. Burgh Bdy.
BP BS Boundary Post or Stone **P.C.B** Police Call Box
B.R. Bridle Road **P** Pump
E.P Electricity Pylon **S.P** Signal Post
F.B. Foot Bridge **Sl** Sluice
F.P. Foot Path **Sp.** Spring
G.P Guide Post or Board **T.C.B** Telephone Call Box
M.S Mile Stone **Tr.** Trough
M.P M.R Mooring Post or Ring **W** Well

Ordnance Survey Plan, Additional SIMs and Supply of Unpublished Survey Information 1:2,500 and 1:1,250

Inactive Quarry, Chalk Pit or Clay Pit **Active Quarry, Chalk Pit or Clay Pit**
Rock **Boulders**
Cliff **Slopes** **Top**
Roofed Building **Glazed Roof Building**
Sloping Masonry **Archway**
Non-Coniferous Tree (surveyed) **Coniferous Tree (surveyed)**
Non-Coniferous Trees (not surveyed) **Coniferous Trees (not surveyed)**
Orchard Tree **Scrub** **Bracken**
Coppice, Osier **Reeds** **Marsh, Saltings**
Rough Grassland **Heath** **Culvert**
Direction of water flow **Bench Mark** **Antiquity (site of)**
Cave Entrance **Triangulation Station** **Electricity Pylon**
Electricity Transmission Line
County Boundary (Geographical)
County & Civil Parish Boundary
Civil Parish Boundary
Admin. County or County Bor. Boundary
London Borough Boundary
Symbol marking point where boundary mereing changes
BH Beer House **P** Pillar, Pole or Post
BP, BS Boundary Post or Stone **PO** Post Office
Cn, C Capstan, Crane **PC** Public Convenience
Chy Chimney **PH** Public House
D Fn Drinking Fountain **Pp** Pump
EI P Electricity Pillar or Post **SB, S Br** Signal Box or Bridge
FAP Fire Alarm Pillar **SP, SL** Signal Post or Light
FB Foot Bridge **Spr** Spring
GP Guide Post **Tk** Tank or Track
H Hydrant or Hydraulic **TCB** Telephone Call Box
LC Level Crossing **TCP** Telephone Call Post
MH Manhole **Tr** Trough
MP Mile Post or Mooring Post **Wr Pt, Wr T** Water Point, Water Tap
MS Mile Stone **W** Well
NTL Normal Tidal Limit **Wd Pp** Wind Pump

Large-Scale National Grid Data 1:2,500 and 1:1,250

Cliff **Slopes** **Top**
Rock **Rock (scattered)**
Boulders **Boulders (scattered)**
Positioned Boulder **Scree**
Non-Coniferous Tree (surveyed) **Coniferous Tree (surveyed)**
Non-Coniferous Trees (not surveyed) **Coniferous Trees (not surveyed)**
Orchard Tree **Scrub** **Bracken**
Coppice, Osier **Reeds** **Marsh, Saltings**
Rough Grassland **Heath** **Culvert**
Direction of water flow **Triangulation Station** **Antiquity (site of)**
Electricity Transmission Line **Electricity Pylon**
B.M. 231.60m Bench Mark **Buildings with Building Seed**
Roofed Building **Glazed Roof Building**
Civil parish/community boundary
District boundary
County boundary
Boundary post/stone
Boundary mereing symbol (note: these always appear in opposed pairs or groups of three)
Bks Barracks **P** Pillar, Pole or Post
Bty Battery **PO** Post Office
Cemy Cemetery **PC** Public Convenience
Chy Chimney **Pp** Pump
Cis Cistern **Ppg Sta** Pumping Station
Dismtd Rly Dismantled Railway **PW** Place of Worship
EI Gen Sta Electricity Generating Station **Sewage Ppg Sta** Sewage Pumping Station
EI P Electricity Pole, Pillar **SB, S Br** Signal Box or Bridge
EI Sub Sta Electricity Sub Station **SP, SL** Signal Post or Light
FB Filter Bed **Spr** Spring
Fn / D Fn Fountain / Drinking Ftn. **Tk** Tank or Track
Gas Gov Gas Valve Compound **Tr** Trough
GVC Gas Governor **Wd Pp** Wind Pump
GP Guide Post **Wr Pt, Wr T** Water Point, Water Tap
MH Manhole **Wks** Works (building or area)
MP, MS Mile Post or Mile Stone **W** Well

Envirocheck®

LANDMARK INFORMATION GROUP®

Historical Mapping & Photography included:

Mapping Type	Scale	Date	Pg
Essex	1:2,500	1876	2
Suffolk	1:2,500	1886	3
Suffolk	1:2,500	1904	4
Suffolk	1:2,500	1926	5
Ordnance Survey Plan	1:2,500	1959 - 1960	6
Ordnance Survey Plan	1:2,500	1971	7
Additional SIMs	1:2,500	1978	8
Additional SIMs	1:2,500	1989	9
Large-Scale National Grid Data	1:2,500	1994	10
Historical Aerial Photography	1:2,500	1999	11

Historical Map - Segment A13

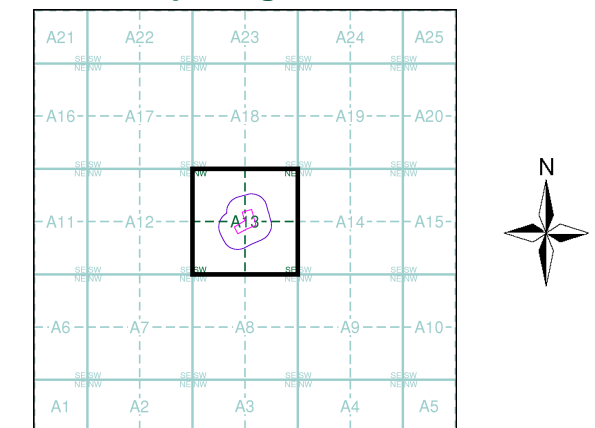

Order Details

Order Number: 272302113_1_1
 Customer Ref: 5449_DS (AT)
 National Grid Reference: 568550, 247000
 Slice: A
 Site Area (Ha): 1.04
 Search Buffer (m): 100

Site Details

Little Court, Haverhill Road, Little Wratting, HAVERHILL, CB9 7UD

Landmark®
 LANDMARK INFORMATION GROUP

Tel: 0844 844 9952
 Fax: 0844 844 9951
 Web: www.envirocheck.co.uk

Essex

Published 1876

Source map scale - 1:2,500

The historical maps shown were reproduced from maps predominantly held at the scale adopted for England, Wales and Scotland in the 1840's. In 1854 the 1:2,500 scale was adopted for mapping urban areas and by 1896 it covered the whole of what were considered to be the cultivated parts of Great Britain. The published date given below is often some years later than the surveyed date. Before 1938, all OS maps were based on the Cassini Projection, with independent surveys of a single county or group of counties, giving rise to significant inaccuracies in outlying areas.

Map Name(s) and Date(s)

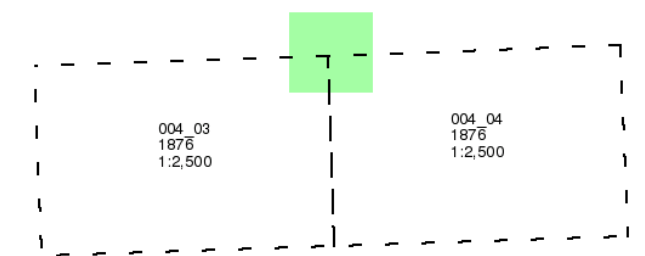

Historical Map - Segment A13

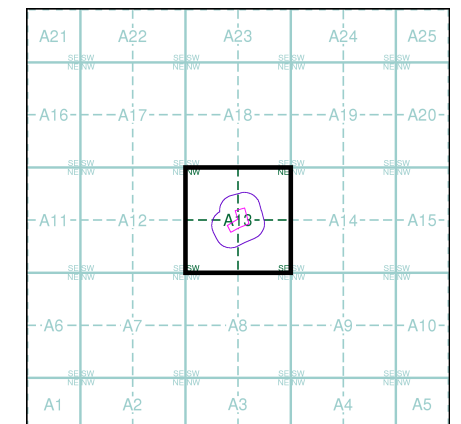

Order Details

Order Number: 272302113_1_1
Customer Ref: 5449_DS (AT)
National Grid Reference: 568550, 247000
Slice: A
Site Area (Ha): 1.04
Search Buffer (m): 100

Site Details

Little Court, Haverhill Road, Little Wratting, HAVERHILL, CB9 7UD

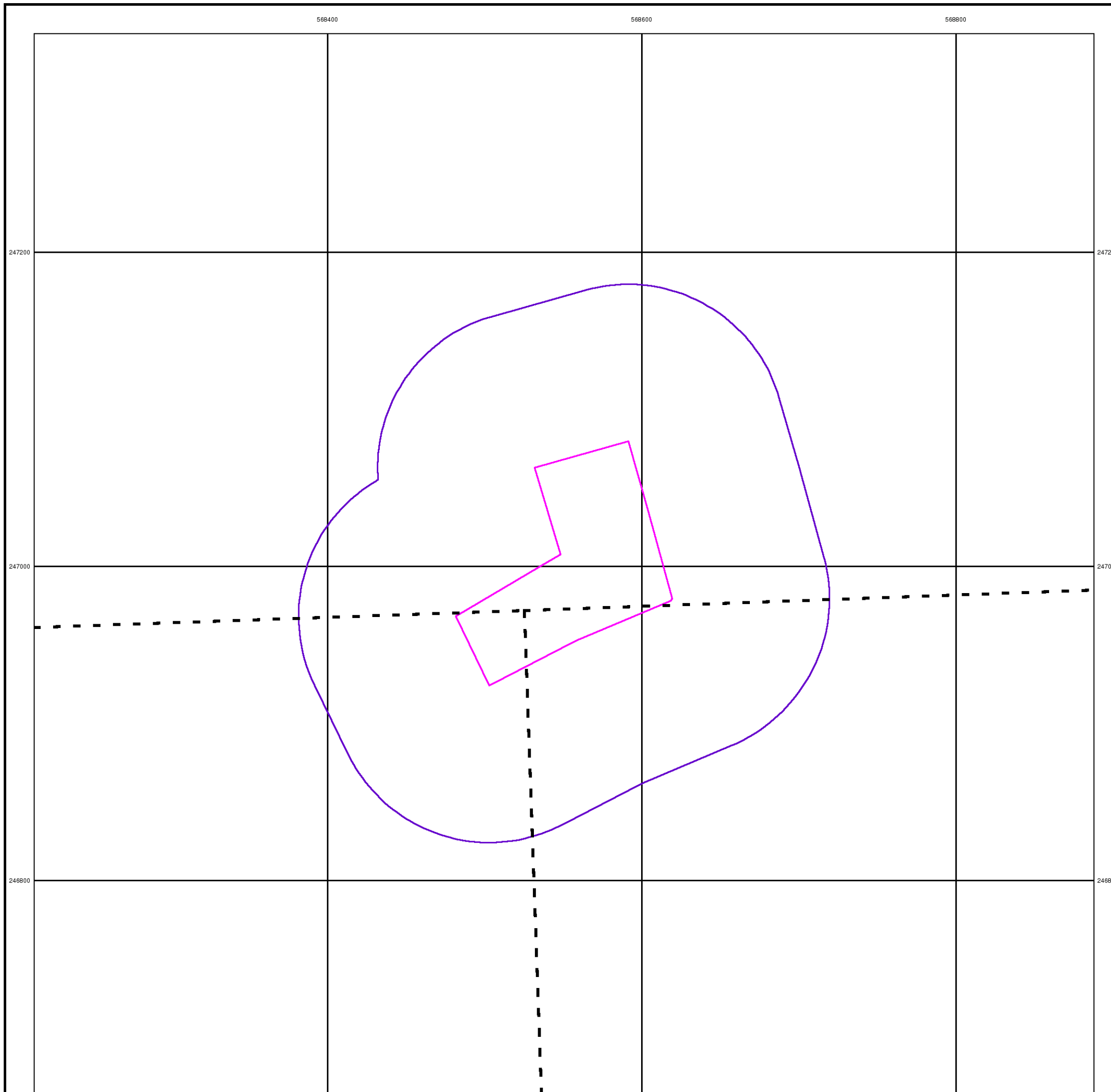

The historical maps shown were reproduced from maps predominantly held at the scale adopted for England, Wales and Scotland in the 1840's. In 1854 the 1:2,500 scale was adopted for mapping urban areas and by 1896 it covered the whole of what were considered to be the cultivated parts of Great Britain. The published date given below is often some years later than the surveyed date. Before 1938, all OS maps were based on the Cassini Projection, with independent surveys of a single county or group of counties, giving rise to significant inaccuracies in outlying areas.

Map Name(s) and Date(s)

061_15 1886 1:2,500	061_16 1886 1:2,500
070_03 1886 1:2,500	070_04 1886 1:2,500

Historical Map - Segment A13

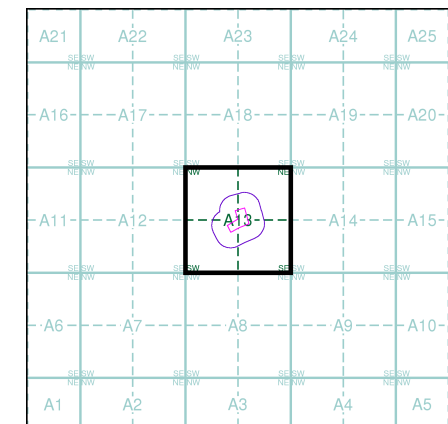

Order Details

Order Number: 272302113_1_1
 Customer Ref: 5449_DS (AT)
 National Grid Reference: 568550, 247000
 Slice: A
 Site Area (Ha): 1.04
 Search Buffer (m): 100

Site Details

Little Court, Haverhill Road, Little Wratting, HAVERHILL, CB9 7UD

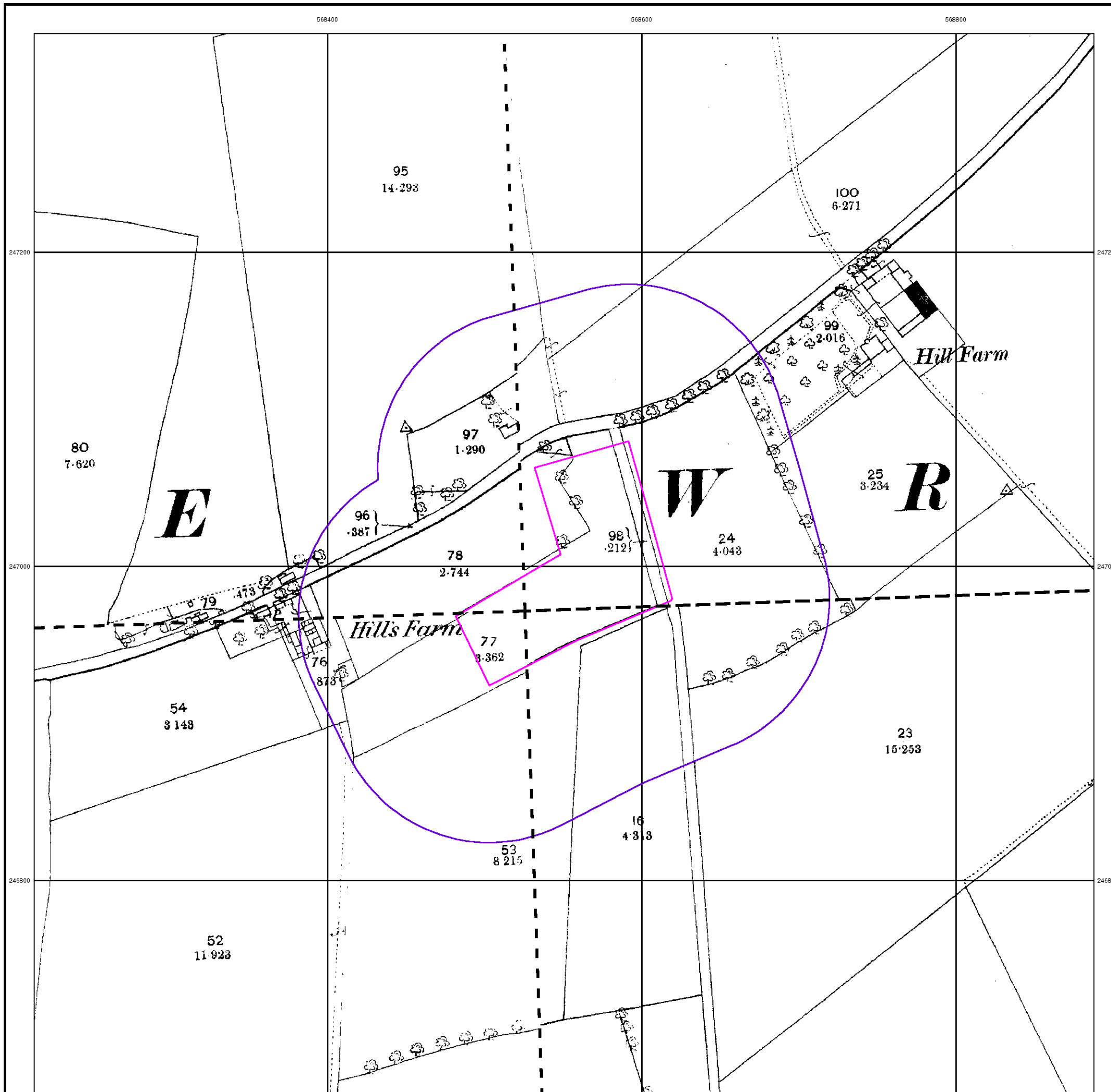

The historical maps shown were reproduced from maps predominantly held at the scale adopted for England, Wales and Scotland in the 1840's. In 1854 the 1:2,500 scale was adopted for mapping urban areas and by 1896 it covered the whole of what were considered to be the cultivated parts of Great Britain. The published date given below is often some years later than the surveyed date. Before 1938, all OS maps were based on the Cassini Projection, with independent surveys of a single county or group of counties, giving rise to significant inaccuracies in outlying areas.

Map Name(s) and Date(s)

061_15 1904 1:2,500	061_16 1904 1:2,500
070_03 1904 1:2,500	070_04 1904 1:2,500

Historical Map - Segment A13

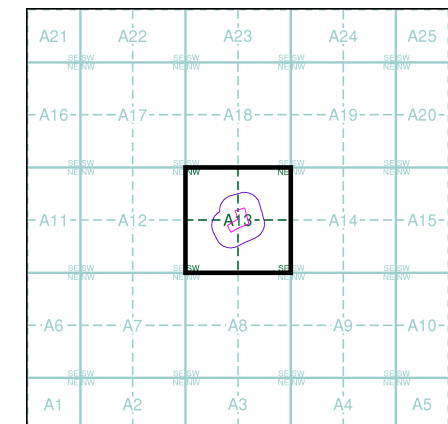

Order Details

Order Number: 272302113_1_1
 Customer Ref: 5449_DS (AT)
 National Grid Reference: 568550, 247000
 Slice: A
 Site Area (Ha): 1.04
 Search Buffer (m): 100

Site Details

Little Court, Haverhill Road, Little Wratting, HAVERHILL, CB9 7UD

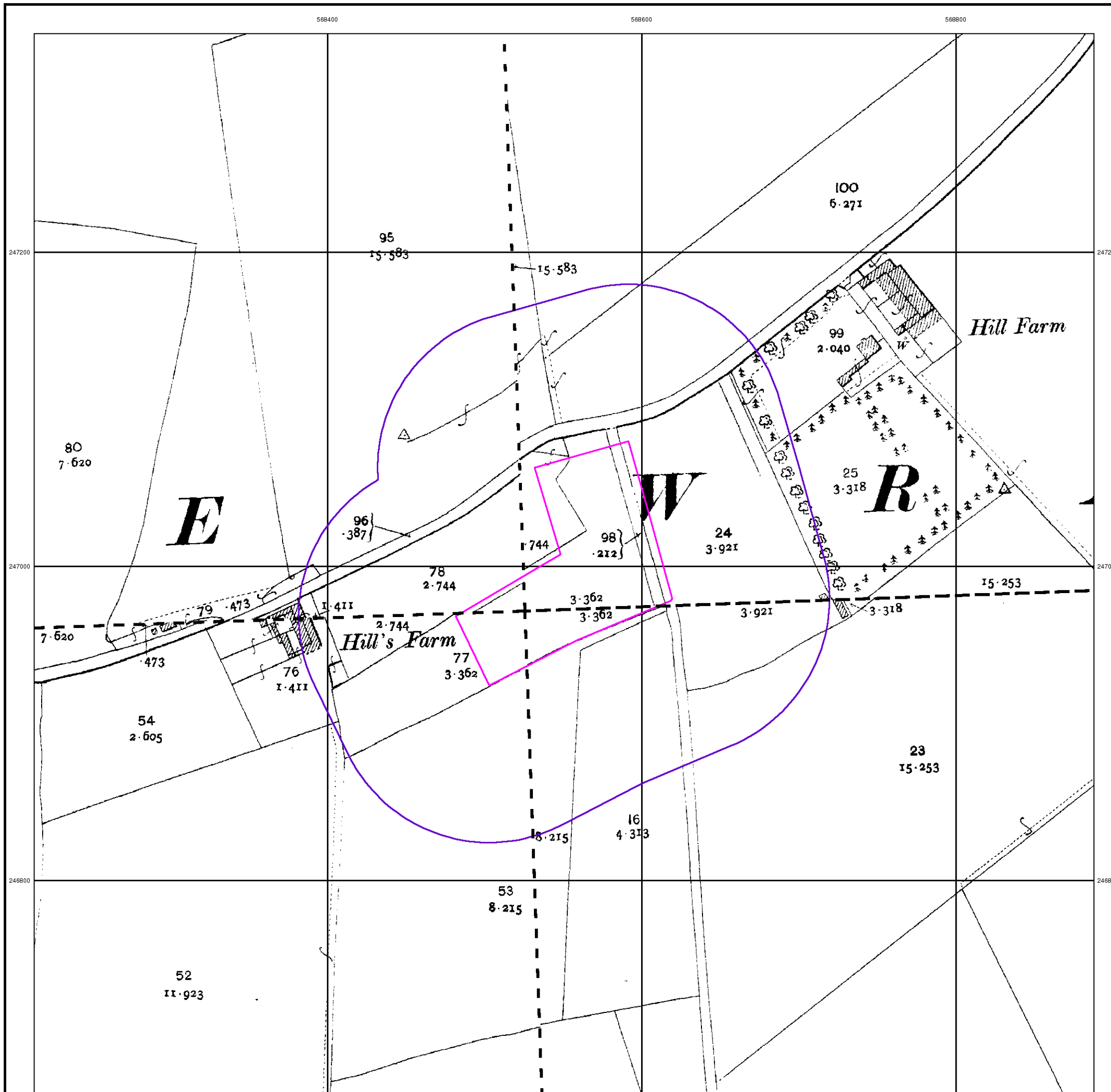

The historical maps shown were reproduced from maps predominantly held at the scale adopted for England, Wales and Scotland in the 1840's. In 1854 the 1:2,500 scale was adopted for mapping urban areas and by 1896 it covered the whole of what were considered to be the cultivated parts of Great Britain. The published date given below is often some years later than the surveyed date. Before 1938, all OS maps were based on the Cassini Projection, with independent surveys of a single county or group of counties, giving rise to significant inaccuracies in outlying areas.

Map Name(s) and Date(s)

061_15 1926 1:2,500	061_16 1926 1:2,500
070_03 1926 1:2,500	070_04 1926 1:2,500

Historical Map - Segment A13

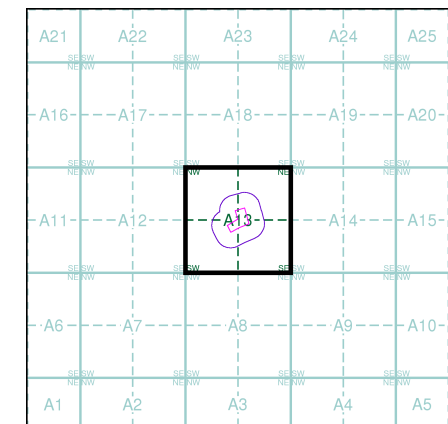

Order Details

Order Number: 272302113_1_1
 Customer Ref: 5449_DS (AT)
 National Grid Reference: 568550, 247000
 Slice: A
 Site Area (Ha): 1.04
 Search Buffer (m): 100

Site Details

Little Court, Haverhill Road, Little Wratting, HAVERHILL, CB9 7UD

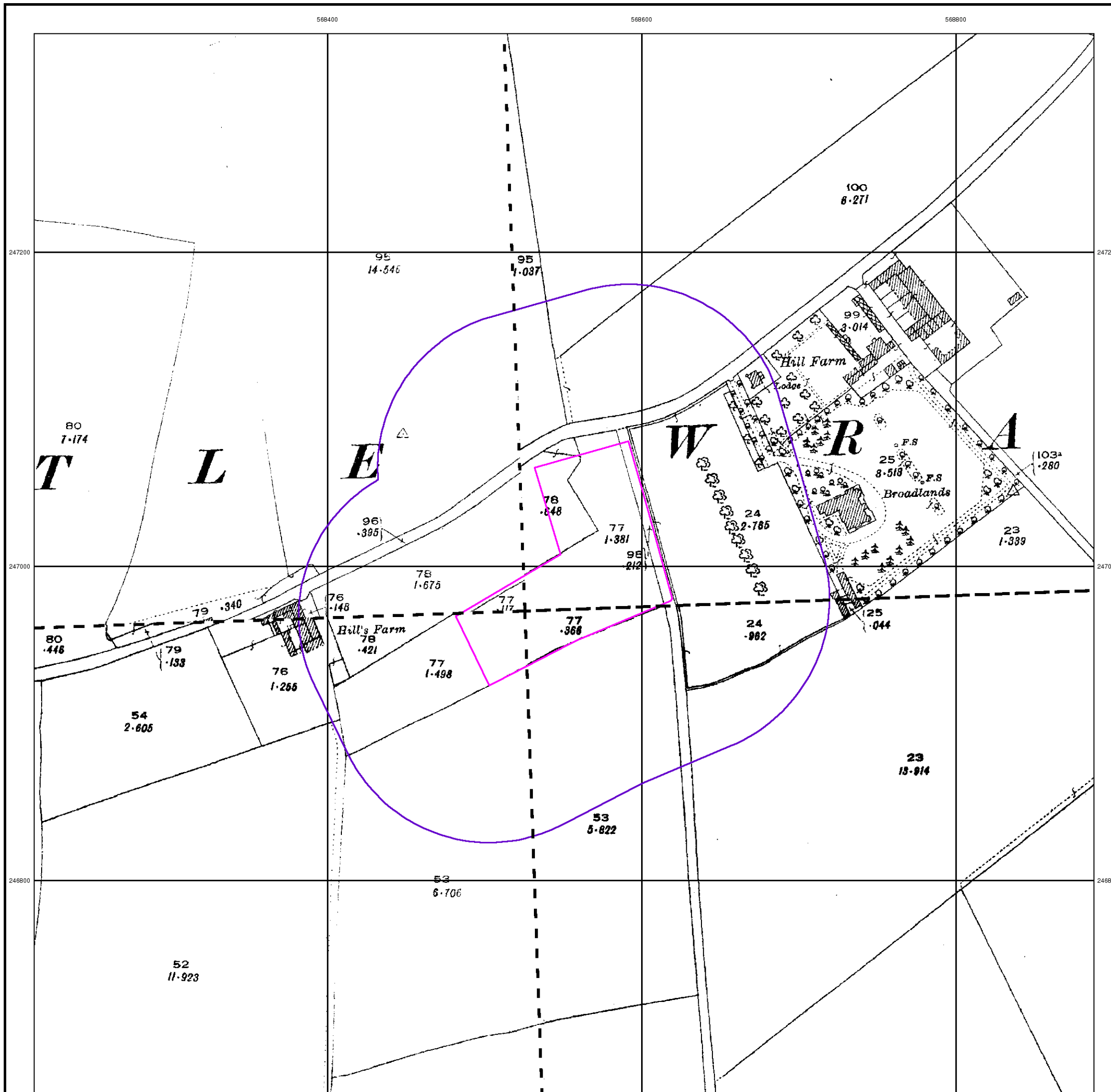

Ordnance Survey Plan

Published 1959 - 1960

Source map scale - 1:2,500

The historical maps shown were reproduced from maps predominantly held at the scale adopted for England, Wales and Scotland in the 1840's. In 1854 the 1:2,500 scale was adopted for mapping urban areas and by 1896 it covered the whole of what were considered to be the cultivated parts of Great Britain. The published date given below is often some years later than the surveyed date. Before 1938, all OS maps were based on the Cassini Projection, with independent surveys of a single county or group of counties, giving rise to significant inaccuracies in outlying areas.

Map Name(s) and Date(s)

TL6847	1960	1:2,500
TL6846	1959	1:2,500

Historical Map - Segment A13

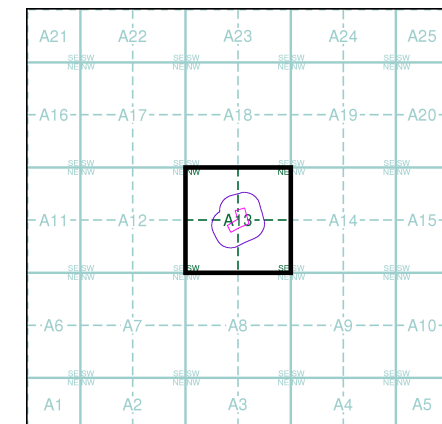

Order Details

Order Number: 272302113_1_1
 Customer Ref: 5449_DS (AT)
 National Grid Reference: 568550, 247000
 Slice: A
 Site Area (Ha): 1.04
 Search Buffer (m): 100

Site Details

Little Court, Haverhill Road, Little Wrating, HAVERHILL, CB9 7UD

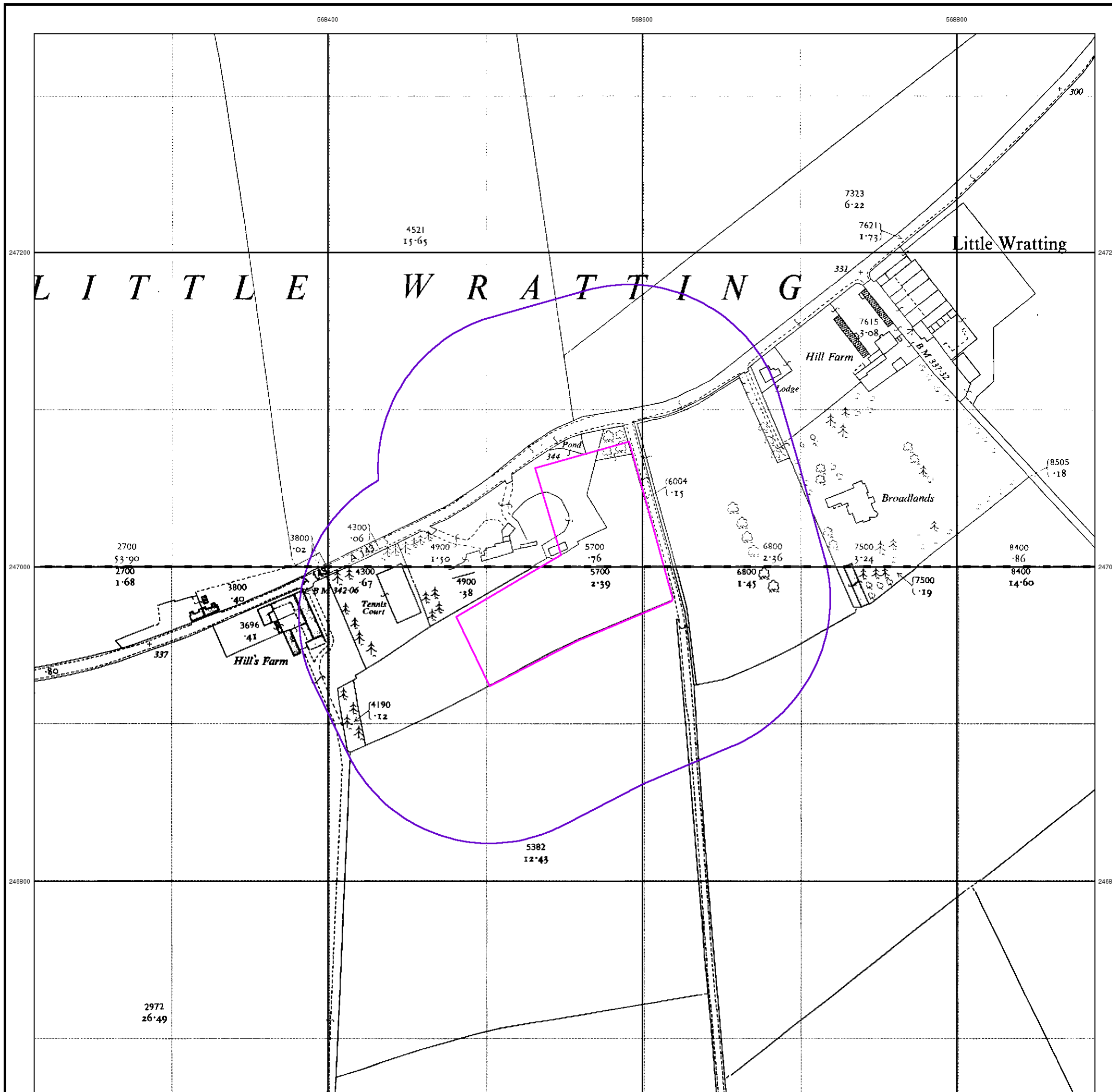

Ordnance Survey Plan

Published 1971

Source map scale - 1:2,500

The historical maps shown were reproduced from maps predominantly held at the scale adopted for England, Wales and Scotland in the 1840's. In 1854 the 1:2,500 scale was adopted for mapping urban areas and by 1896 it covered the whole of what were considered to be the cultivated parts of Great Britain. The published date given below is often some years later than the surveyed date. Before 1938, all OS maps were based on the Cassini Projection, with independent surveys of a single county or group of counties, giving rise to significant inaccuracies in outlying areas.

Map Name(s) and Date(s)

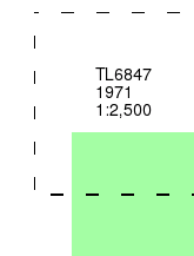

Historical Map - Segment A13

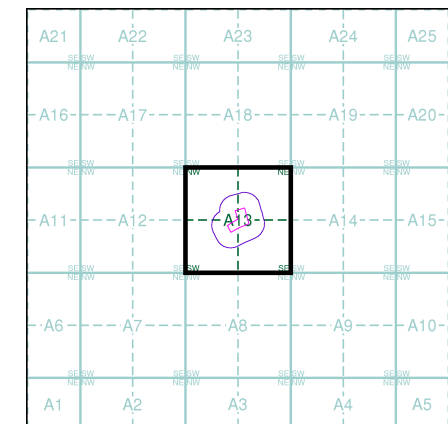

Order Details

Order Number: 272302113_1_1
 Customer Ref: 5449_DS (AT)
 National Grid Reference: 568550, 247000
 Slice: A
 Site Area (Ha): 1.04
 Search Buffer (m): 100

Site Details

Little Court, Haverhill Road, Little Wrating, HAVERHILL, CB9 7UD

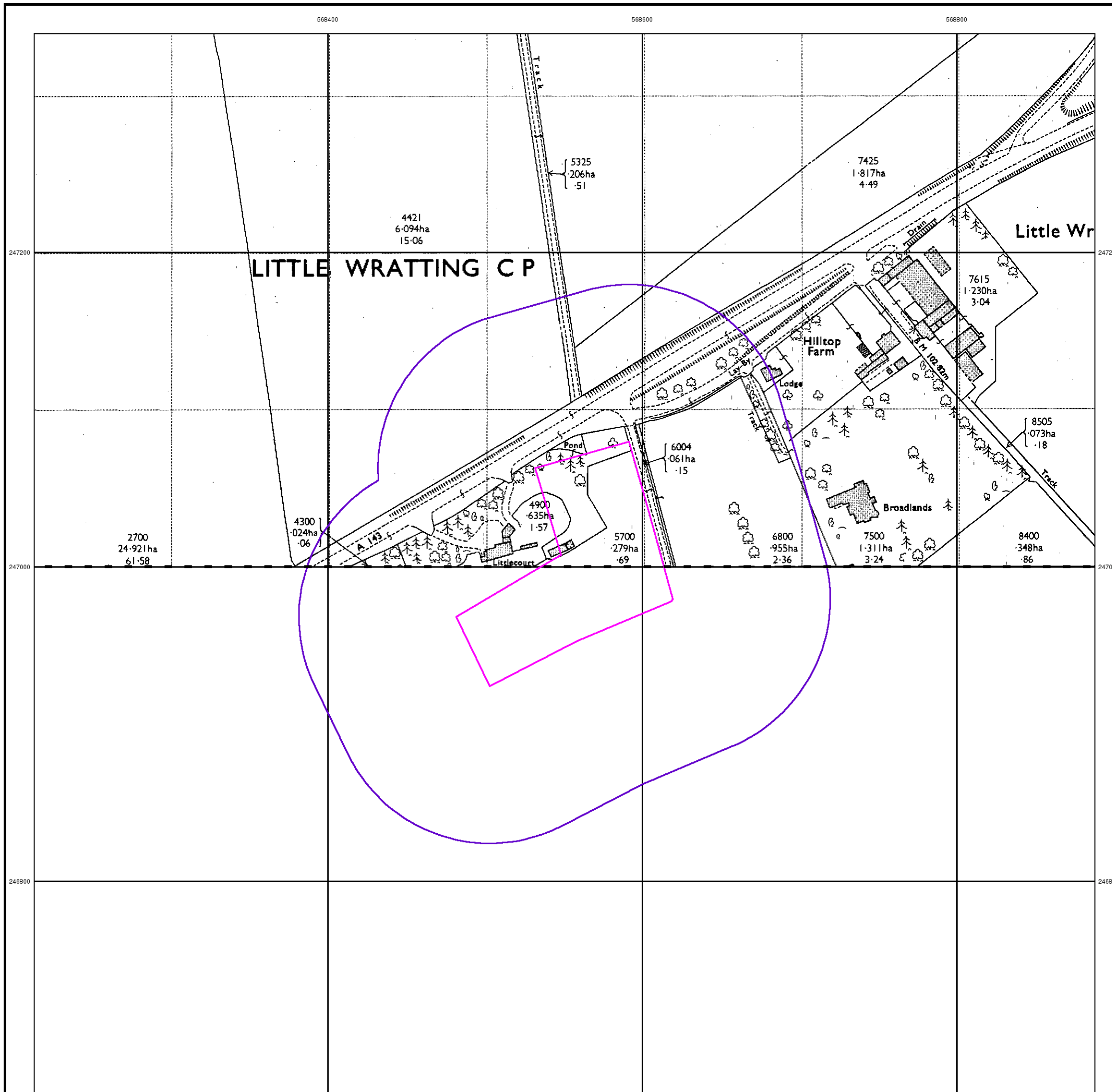

Additional SIMs

Published 1978

Source map scale - 1:2,500

The SIM cards (Ordnance Survey's 'Survey of Information on Microfilm') are further, minor editions of mapping which were produced and published in between the main editions as an area was updated. They date from 1947 to 1994, and contain detailed information on buildings, roads and land-use. These maps were produced at both 1:2,500 and 1:1,250 scales.

Map Name(s) and Date(s)

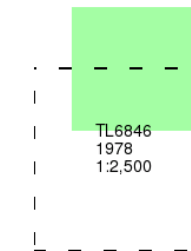

Historical Map - Segment A13

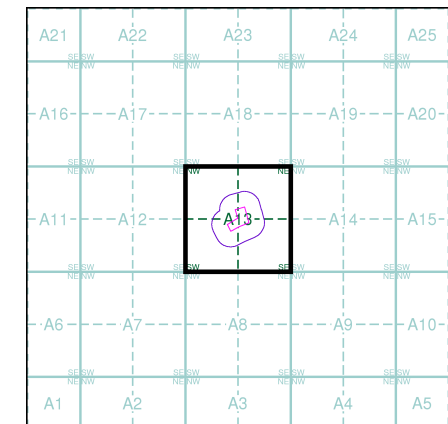

Order Details

Order Number: 272302113_1_1
 Customer Ref: 5449_DS (AT)
 National Grid Reference: 568550, 247000
 Slice: A
 Site Area (Ha): 1.04
 Search Buffer (m): 100

Site Details

Little Court, Haverhill Road, Little Wratting, HAVERHILL, CB9 7UD

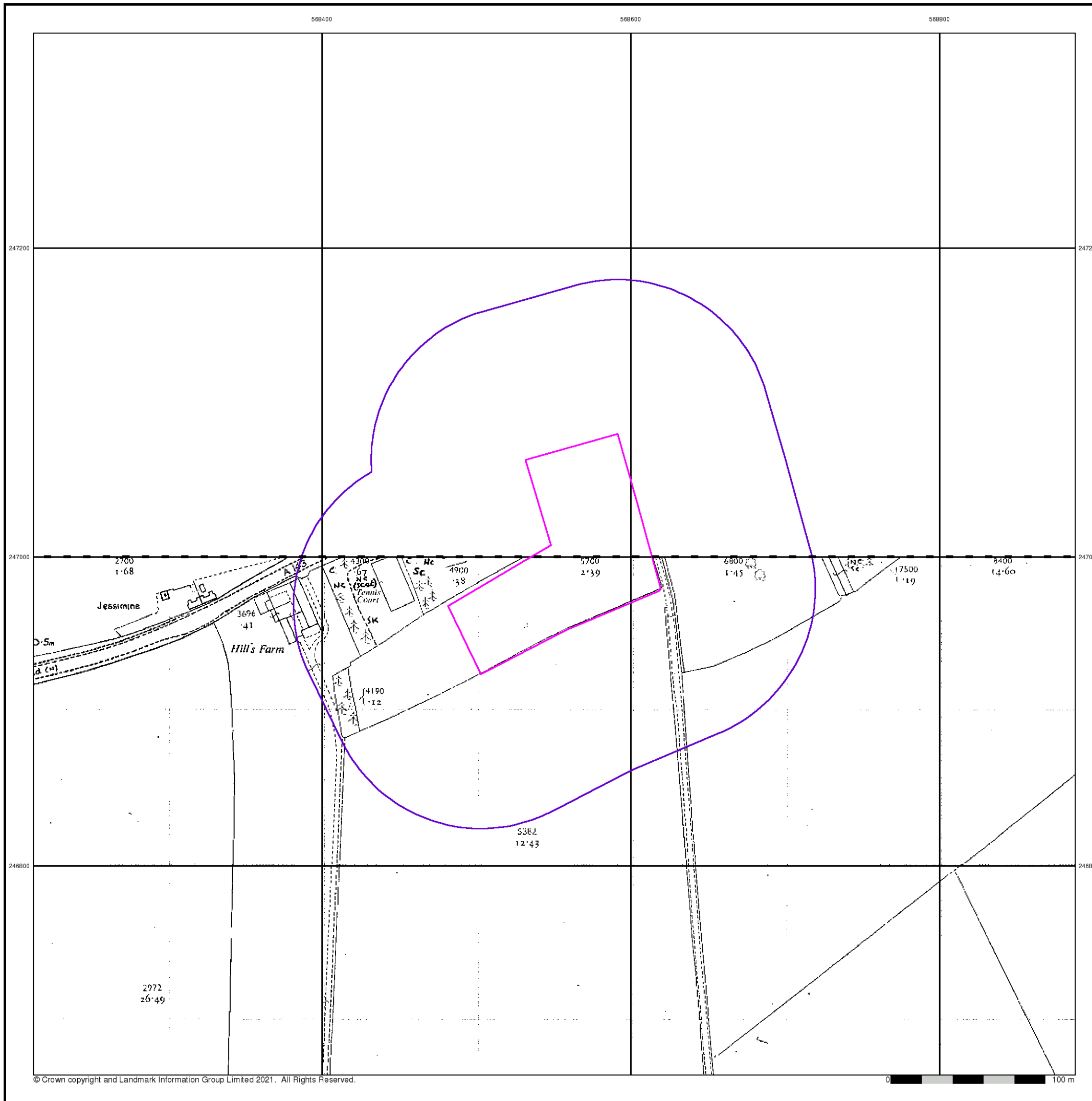

Additional SIMs

Published 1989

Source map scale - 1:2,500

The SIM cards (Ordnance Survey's 'Survey of Information on Microfilm') are further, minor editions of mapping which were produced and published in between the main editions as an area was updated. They date from 1947 to 1994, and contain detailed information on buildings, roads and land-use. These maps were produced at both 1:2,500 and 1:1,250 scales.

Map Name(s) and Date(s)

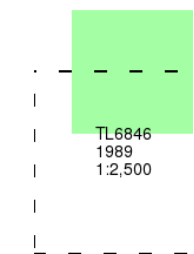

Historical Map - Segment A13

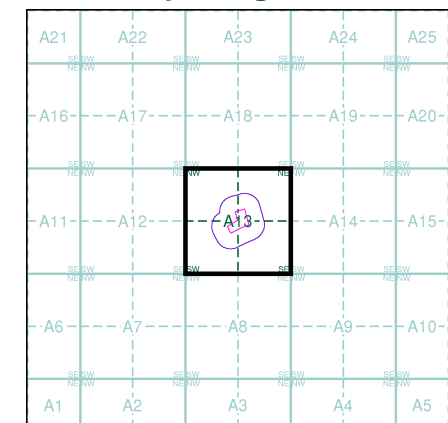

Order Details

Order Number: 272302113_1_1
Customer Ref: 5449_DS (AT)
National Grid Reference: 568550, 247000
Slice: A
Site Area (Ha): 1.04
Search Buffer (m): 100

Site Details

Little Court, Haverhill Road, Little Wratting, HAVERHILL, CB9 7UD

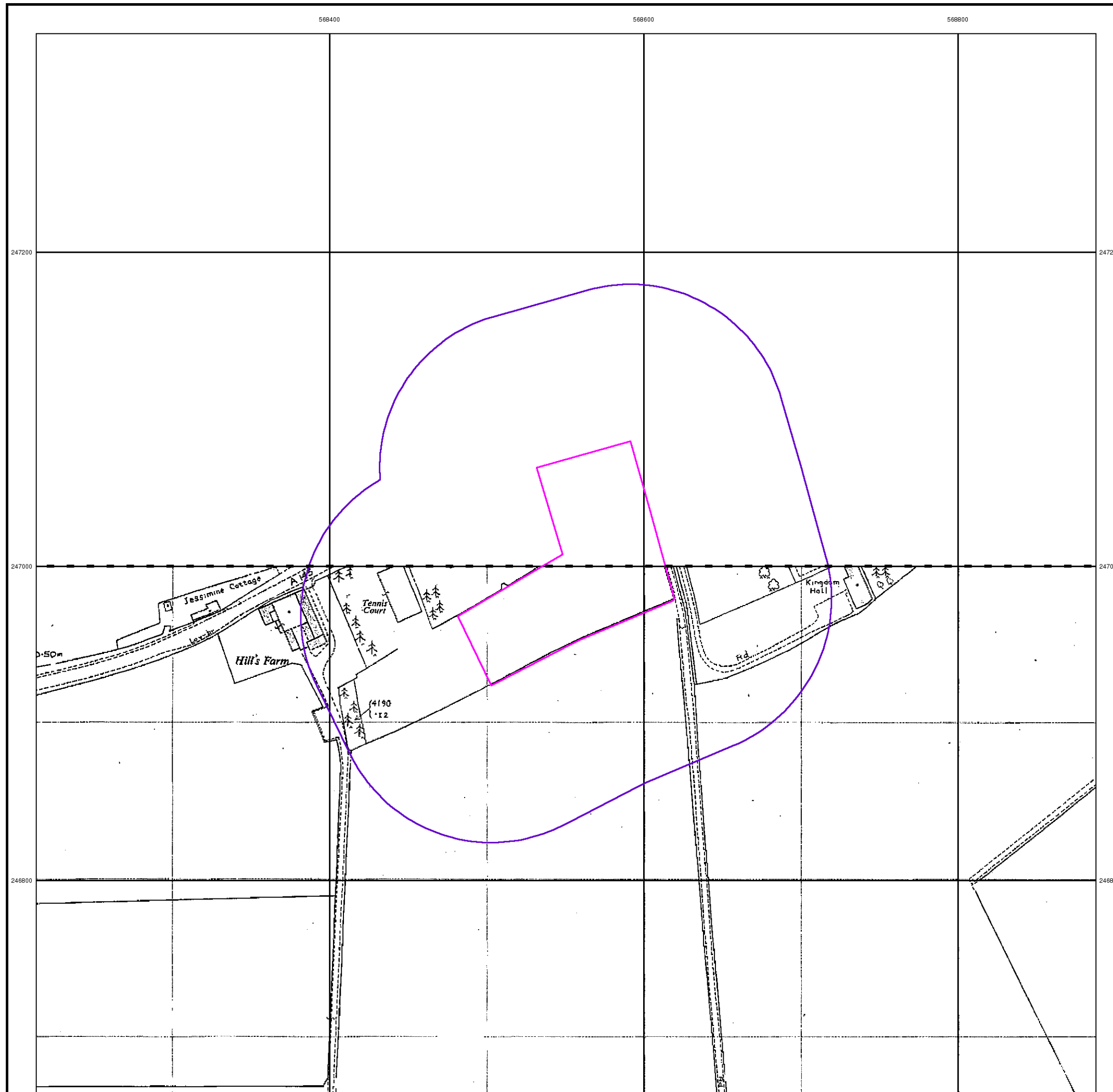

Large-Scale National Grid Data

Published 1994

Source map scale - 1:2,500

'Large Scale National Grid Data' superseded SIM cards (Ordnance Survey's 'Survey of Information on Microfilm') in 1992, and continued to be produced until 1999. These maps were the fore-runners of digital mapping and so provide detailed information on houses and roads, but tend to show less topographic features such as vegetation. These maps were produced at both 1:2,500 and 1:1,250 scales.

Map Name(s) and Date(s)

TL6847	1994	1:2,500
TL6846	1994	1:2,500

Historical Map - Segment A13

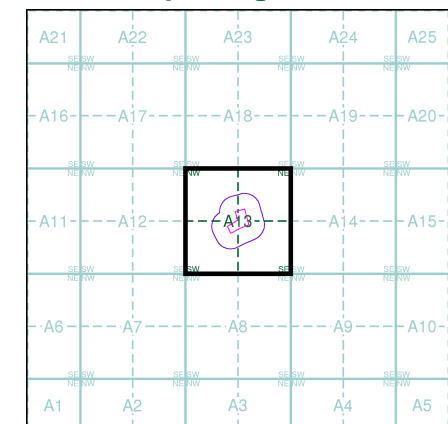

Order Details

Order Number: 272302113_1_1
 Customer Ref: 5449_DS (AT)
 National Grid Reference: 568550, 247000
 Slice: A
 Site Area (Ha): 1.04
 Search Buffer (m): 100

Site Details

Little Court, Haverhill Road, Little Wratting, HAVERHILL, CB9 7UD

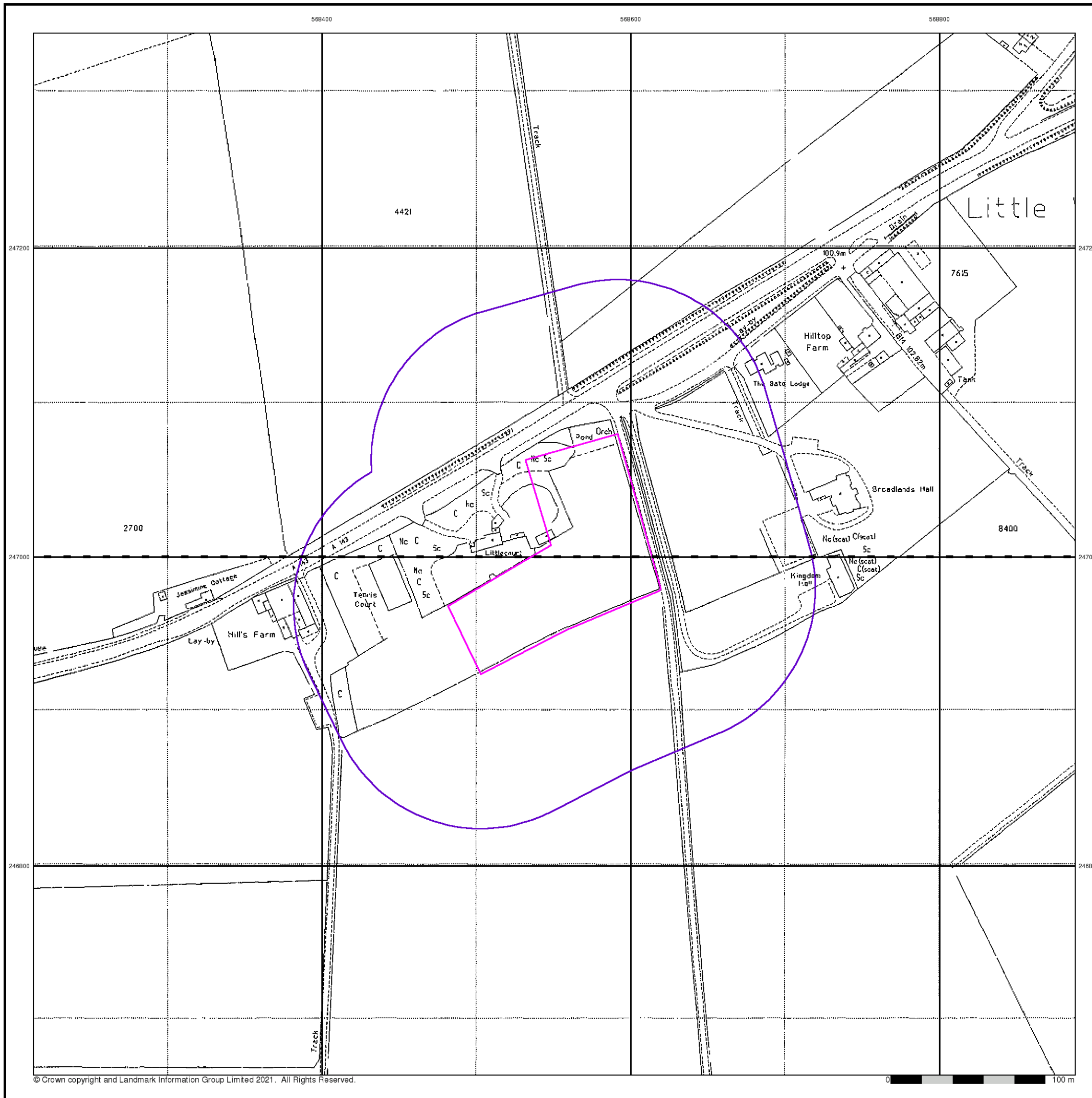

568400

568600

568800

Envirocheck®

● LANDMARK INFORMATION GROUP®

Historical Aerial Photography

Published 1999

This aerial photography was produced by Getmapping, these vertical aerial photographs provide a seamless, full colour survey of the whole of Great Britain

247200

247200

247000

247000

246800

246800



Historical Aerial Photography - Segment A13

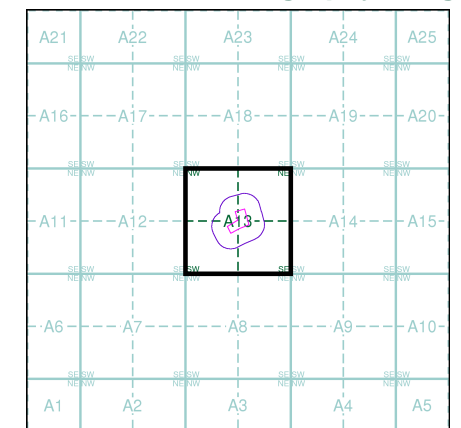

Order Details

Order Number: 272302113_1_1
 Customer Ref: 5449_DS (AT)
 National Grid Reference: 568550, 247000
 Slice: A
 Site Area (Ha): 1.04
 Search Buffer (m): 100

Site Details

Little Court, Haverhill Road, Little Wratting, HAVERHILL, CB9 7UD