

This drawing is the copyright of the architect JBA.  
All dimensions and conditions to be verified on site by the relevant Contractor prior to proceeding.  
...  
Standard industry solutions apply unless otherwise stated.  
All dimensions are in millimeters and are to structural faces or centres unless otherwise stated.  
not to finishes unless otherwise stated.  
Survey by others.  
This drawing must be read in conjunction with all other relevant drawings and specifications from the Architect and other consultants.  
If in doubt, ask.



1.



2.

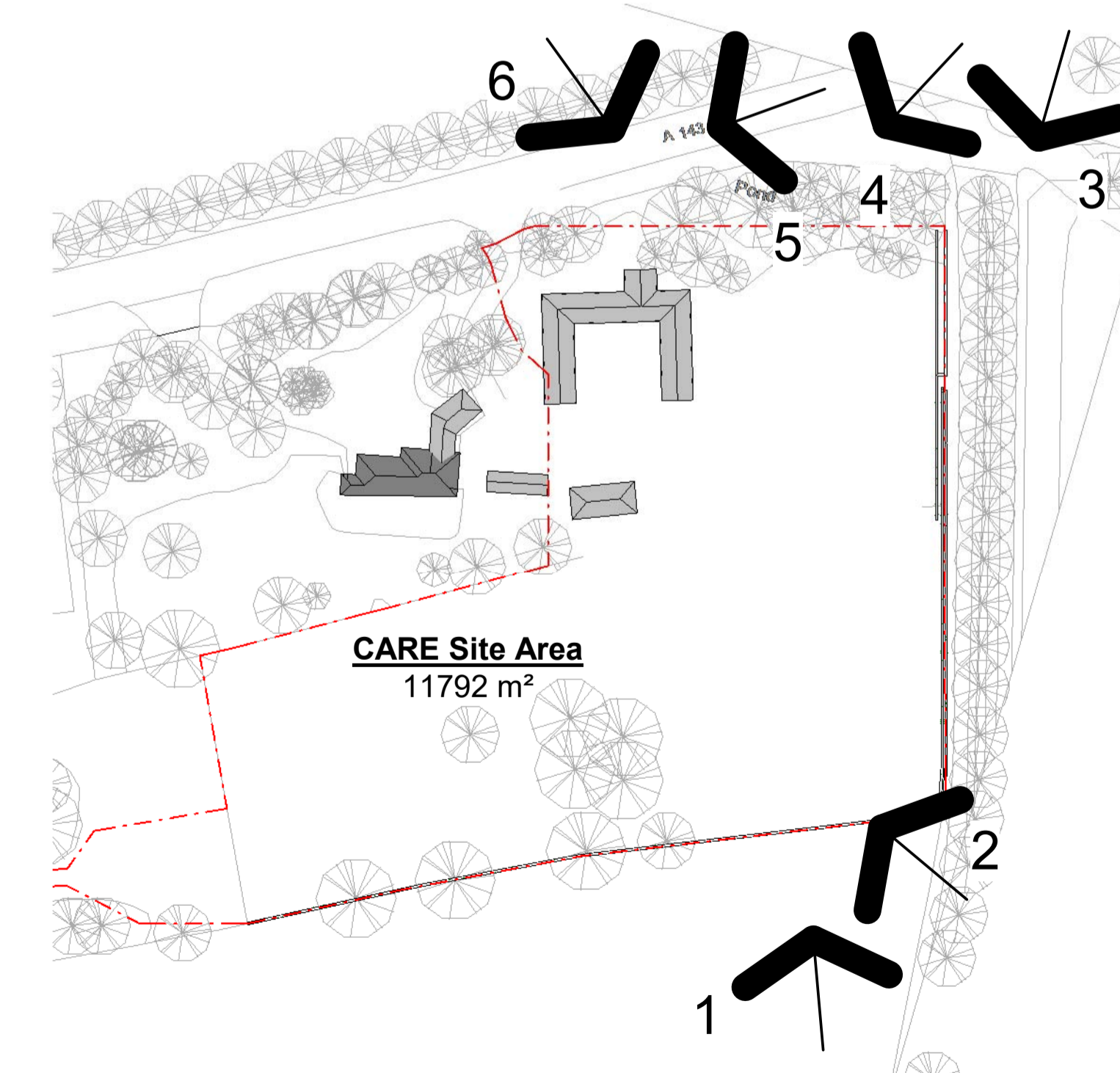

1 Existing Site Key Plan  
1:1000

Rev. DD/MM/YY Initials - Description

## Jordan+Bateman Architects

Head Office: T +44 (0)20 7363 8866  
The Gothic Building F +44 (0)20 7363 1335  
Chantry Mills, High Street jba@jandba.com  
Haverhill, Suffolk, CB9 8AZ, UK www.jandba.com

Project: Little Court  
Client: CARE (Little Court) Ltd  
Drawing: Existing Site Pictures - 1  
Date: 11/06/20  
Scale: 1 : 1000 @ A1  
Drawn By: LE  
Drawing No: 410\_00\_00\_EX\_A\_0050  
Revision  
Preliminary [ X ] Tender [ ] Construction [ ]

# Existing Site Pictures - 1