

This drawing is the copyright of the architect JBA. All dimensions and conditions to be verified on site by the relevant Contractor prior to proceeding.

... Standard industry solutions apply unless otherwise stated. All dimensions are in millimeters and are to structural faces or centres unless otherwise stated. not to finishes unless otherwise stated. Survey by others.

This drawing must be read in conjunction with all other relevant drawings and specifications from the Architect and other consultants. If in doubt, ask.



3.



4.

Existing Site Pictures - 2

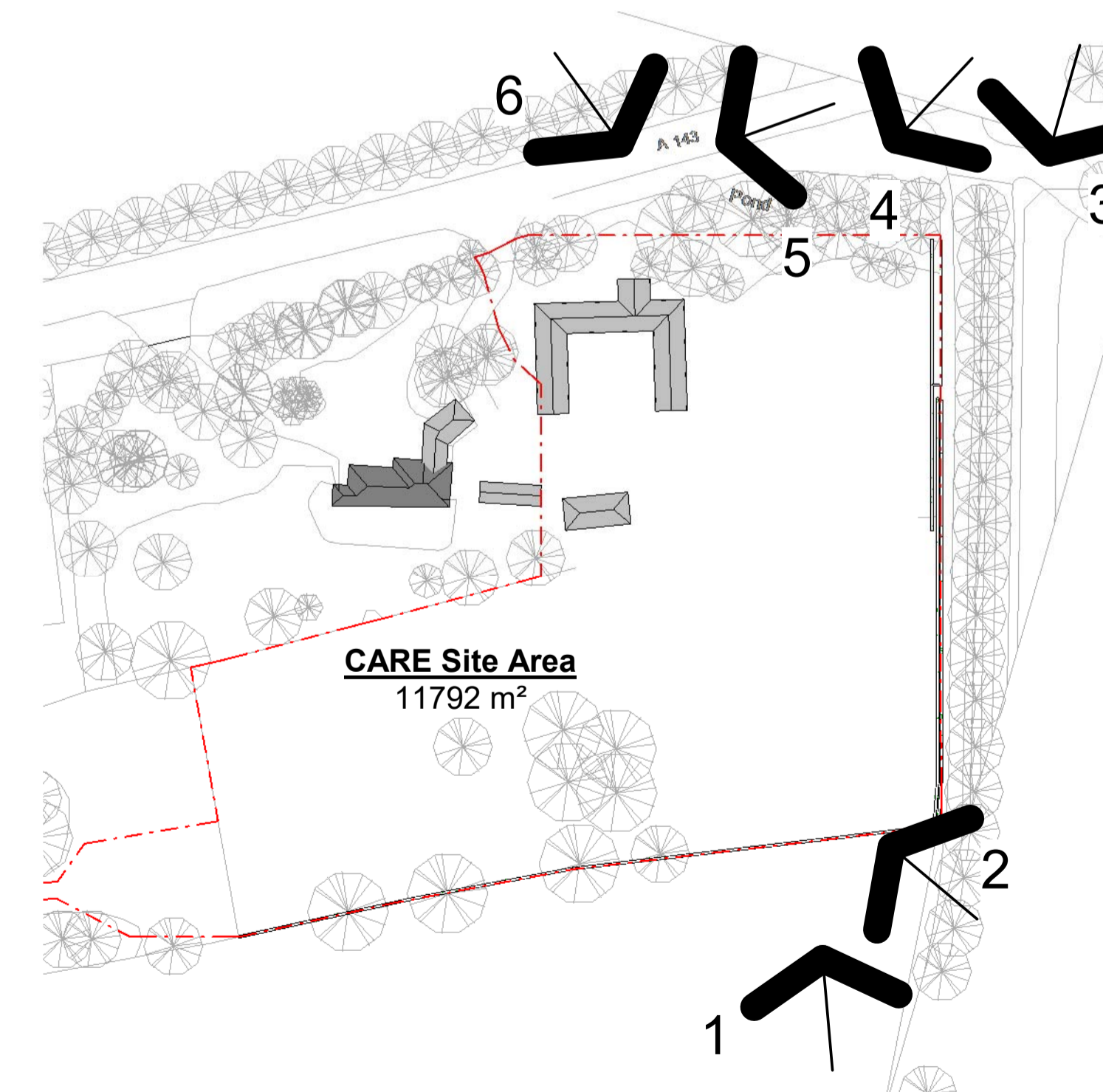

1 Existing Site Key Plan
1:1000

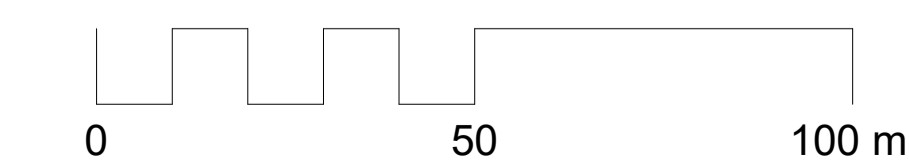

Rev.	DD/MM/YY	Initials	Description

Jordan+Bateman Architects

Head Office: T +44 (0)20 7363 8866
 The Gothic Building F +44 (0)20 7363 1335
 Chantry Mills, High Street jba@jandba.com
 Haverhill, Suffolk, CB9 8AZ, UK www.jandba.com

Project: Little Court

Client: CARE (Little Court) Ltd

Drawing: Existing Site Pictures - 2

Date: 11/06/20

Scale: 1 : 1000 @ A1

Drawn By: LE

Drawing No: 410_00_00_EX_A_0051

Revision

Preliminary [X] Tender [] Construction []