

This drawing is the copyright of the architect JBA.
 All dimensions and conditions to be verified on site by the relevant Contractor prior to proceeding.
 ...
 Standard industry solutions apply unless otherwise stated.
 All dimensions are in millimeters and are to structural faces or centres unless otherwise stated.
 not to finishes unless otherwise stated.
 Survey by others.
 This drawing must be read in conjunction with all other relevant drawings and specifications from the Architect and other consultants.
 If in doubt, ask.

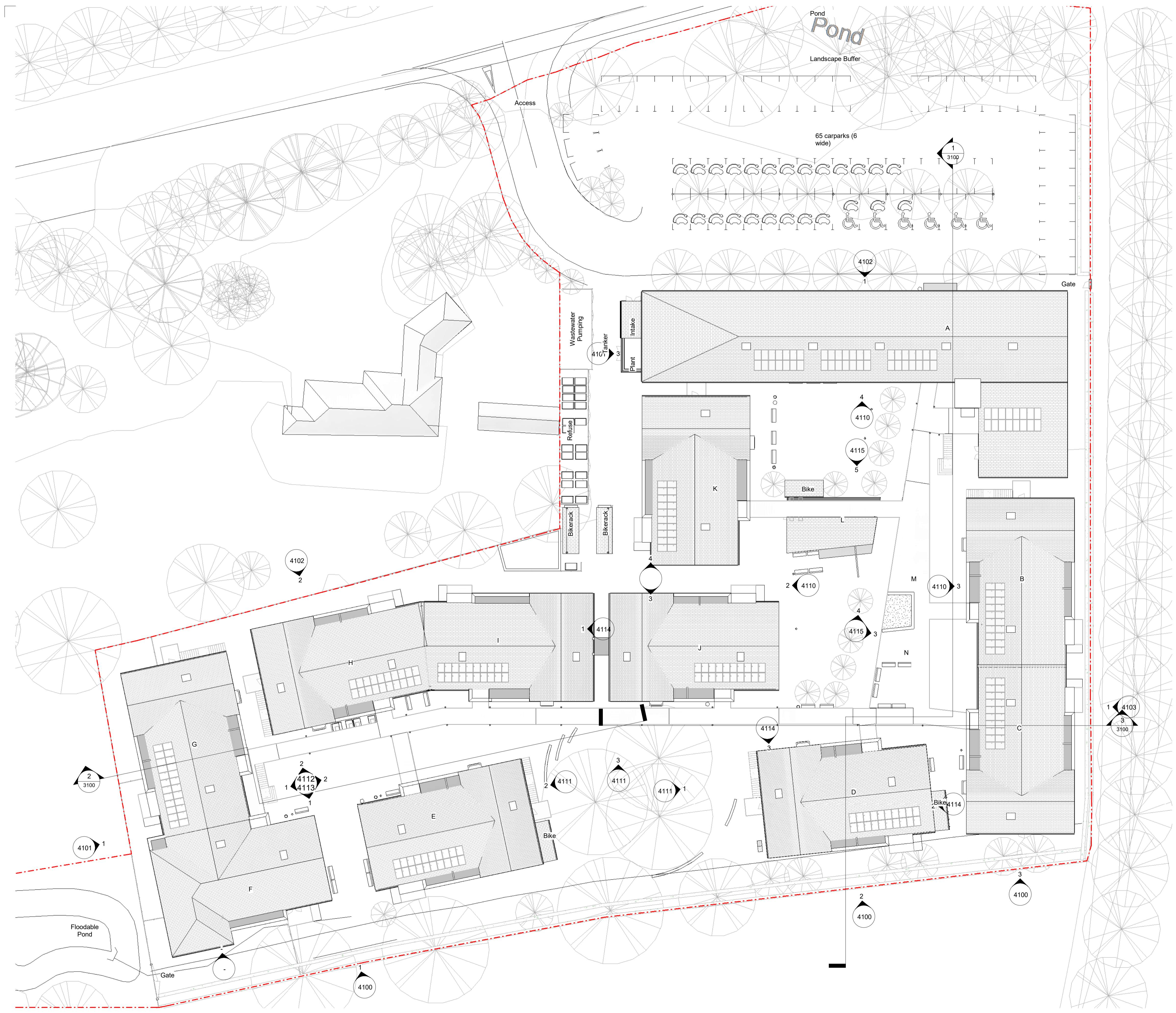

1 05/03/21 Amended as per LA Comments
 Rev. DD/MM/YY Initials - Description

Jordan+Bateman Architects

Head Office: T +44 (0)20 7363 8866
 The Gothic Building F +44 (0)20 7363 1335
 Chauntry Mills, High Street jba@jandba.com
 Haverhill, Suffolk, CB9 8AZ, UK www.jandba.com

| | |
|-------------------|-----------------------------|
| Project: | Little Court |
| Client: | CARE (Little Court) Ltd |
| Drawing: | Key Plan |
| Date: | 29/01/21 |
| Scale: | 1 : 250 @ A1 |
| Drawn By: | LE |
| Drawing No: | 410_00_3R_PL_A_1900 |
| Revision: | 1 |
| Preliminary [X] | Tender [] Construction [] |

Key Plan

