

- Notes**
1. This drawing is copyright and the property of FICL and must not be copied in whole or part without their prior written permission.
 2. This drawing is indicative only and must not be scaled. Layout and dimensions provided are to be verified on site.
 3. Drawings are to be used for Planning permission only.

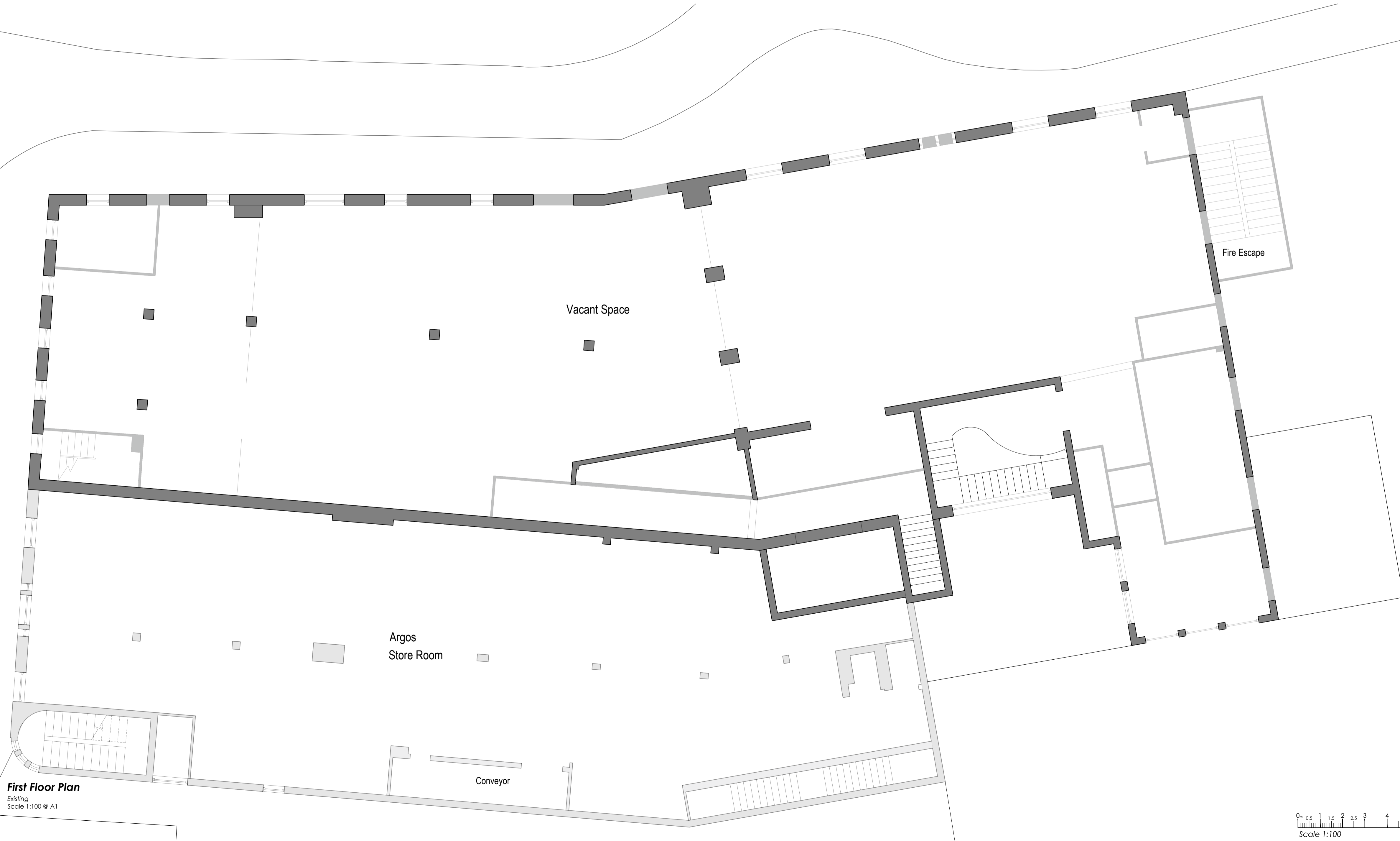

| Rev | By | Notes | Date |
|-----|----|-------|------|
| | | | |

Fairhome
PROPERTY DEVELOPMENTS LTD
Fairhome Group, Quaker Reach, 10 Cavendish Way, Haverhill, NDD 2Y
t: 01473 240000
www.fairhomegroup.co.uk

Project
5 High Street, Haverhill,
St Edmundsbury CB9 8AA

Title
First Floor Plan
Existing

Drawn By TS
Checked AG
Approved JM
Date August 2021

Paper Size A1
DWG Number FP28675-A-002
Revision PL1

