

ELEVATION
CLOSE BOARDED FENCE
@ 1:50

ELEVATION
KNEE RAIL FENCE
@ 1:50

PEDESTRIAN GUARDING & LAMP POST DETAIL
@ 1:50

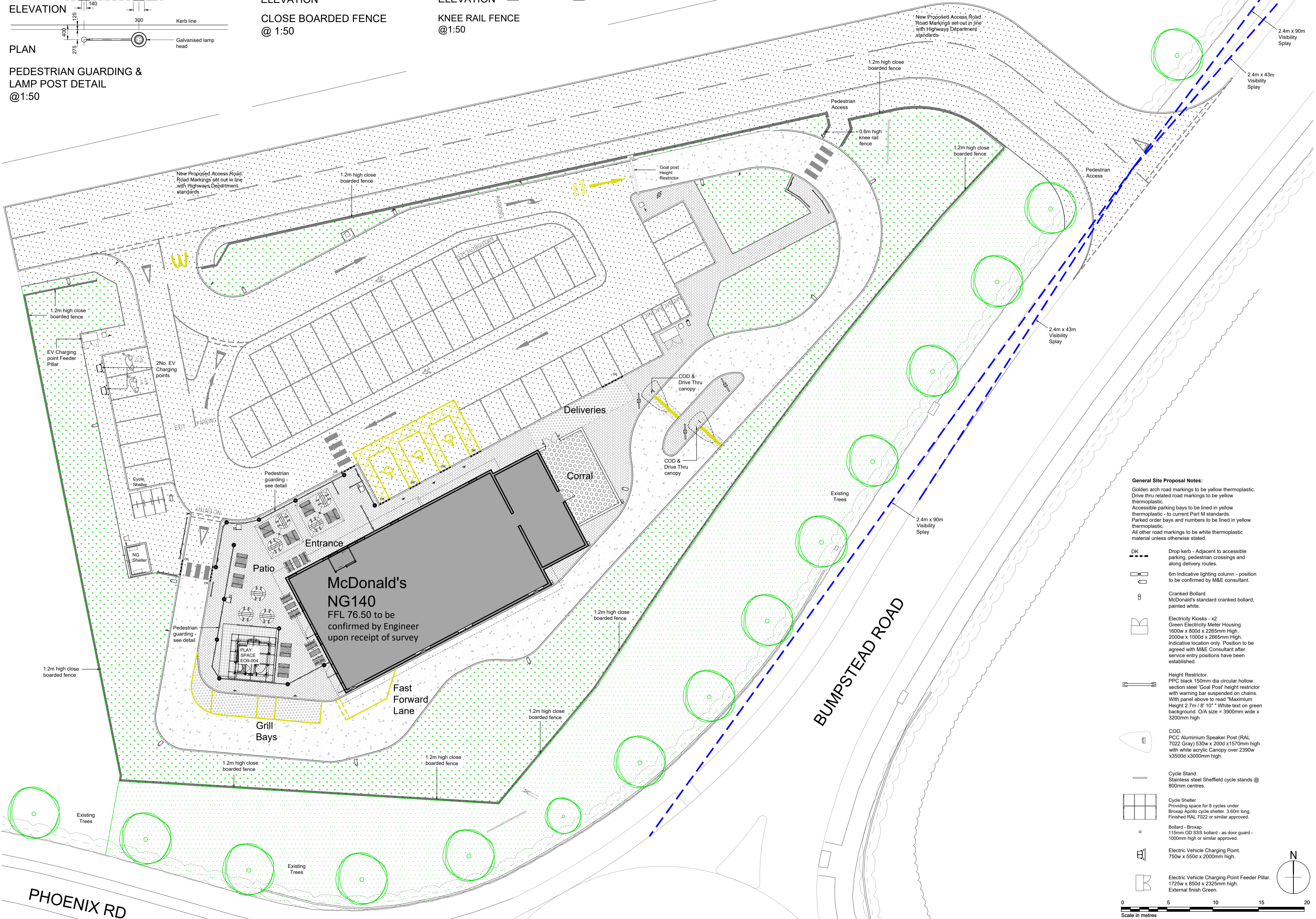

Notes:
All drawings to be read in conjunction with all other drawings as noted on issue sheet.

- Proposed Site Finishes:**
- Tarmacadam - Car park and footpaths as indicated.
 - Marshalls 200 x 100mm Charcoal Keyblok paving - Patio
 - Charcoal imprinted concrete - Drive thru lane.
 - Charcoal brushed concrete - delivery route.
 - Brushed concrete - Corral.
 - Safety floor: Min. 50mm thick wet pour bounded rubber - to be confirmed by Project Manager.
 - Soft landscaping - see drawing No P007 for further details.
 - Existing landscaping to be retained.
 - Tactile blister paving.

External Fixtures & Fittings:

Aubrilam - Range Euroline 3 Mix 2015
Electrogalvanised steel structure, PPC RAL 7022. Table legs made of extruded aluminium, PPC RAL 7022. Table seats & plate in 12mm HPL panel with 12mm beech plywood HPL veneer.
Coffee table, single chair, bench and 2 seat table and round table must be fixed to the ground.

- 4 seats - Round Table.
- 4 seats - Rectangular Table.
- One Armrest Bench (left or right).
- Coffee Table.
- Single Chair.
- Umbrella. 4 x 4m Force 10 umbrella - colour black - with applied Golden arch logo.
- Dust Bin with "Tidy Man" Sticker.
- Ash Bin.
- Pedestrian Guarding 1500mm or 600mm long x 1100mm high. Timber effect galvanised steel.
- Target Trash Bin Combo Delta Large Aperture Litter Bin by Glasdon. 530mm x 470mm high x 1550mm high. Bin body & door: Black.
- Shelter 3400mm x 2400mm x 2300mm high. Steel frame with panels to 3 sides and profile metal roof. Complete with 2No benches and waste bin.
- Play Frame (E09-004) Tubular aluminium climbing frame with coloured (red, white & timber) laminate side panels, clear acrylic windows and fabric roof canopy. 3.8w x 3.8d x 4.5m high. See manufacturers information for further details.

General Site Proposal Notes:

- Golden arch road markings to be yellow thermoplastic.
- Drive thru related road markings to be yellow thermoplastic.
- Accessible parking bays to be lined in yellow thermoplastic - to current Part M standards.
- Parked order bays and numbers to be lined in yellow thermoplastic.
- All other road markings to be white thermoplastic material unless otherwise stated.

- DK Drop kerb - Adjacent to accessible parking, pedestrian crossings and along delivery routes.
- 6m Indicative lighting column - position to be confirmed by M&E consultant.
- Cranked Bollard McDonald's standard cranked bollard, painted white.
- Electricity Kiosks - x2 Green Electricity Meter Housing. 1600w x 800d x 2265mm High. 2000w x 1000d x 2665mm High. Indicative location only. Position to be agreed with M&E Consultant after service entry positions have been established.
- Height Restrictor. PPC black 150mm dia circular hollow section steel "Goal Post" height restrictor with warning bar suspended on chains. With panel above to read "Maximum Height 2.7m / 8' 10" White text on green background. O/A size = 3900mm wide x 3200mm high.
- COD. PCC Aluminium Speaker Post (RAL 7022 Gray) 530w x 200d x 1570mm high with white acrylic Canopy over 2390w x 3500d x 3000mm high.
- Cycle Stand Stainless steel Sheffield cycle stands @ 800mm centres.
- Cycle Shelter Providing space for 8 cycles under Broxap Apollo cycle shelter. 3.60m long. Finished RAL 7022 or similar approved.
- Bollard - Broxap 115mm OD S35 bollard - as door guard - 1000mm high or similar approved.
- Electric Vehicle Charging Point. 750w x 550d x 2000mm high.
- Electric Vehicle Charging Point Feeder Pillar. 1725w x 850d x 2325mm high. External finish Green.

REV.	DATE	DESCRIPTION	DRAWING REVISIONS	BY	CHECKED
B	24.06.22	Revised Pedestrian links.		BV	
A	04.05.22	Visibility splays indicated.		JK	

GENERAL NOTES:
All works are to be undertaken in accordance with the Building Regulations and the latest British Standards.
All proprietary materials and products are to be used as per the manufacturer's recommendations.
All dimensions to be checked on site prior to construction.
All risks assessed to comply with the designer's responsibility under the Construction (Design Management) Regulations 2015.

PROPOSED DEVELOPMENT AT:
Bumpstead Road, Haverrill Business Park
HAVERHILL CB9

STORE No.:
NB 8333

ON BEHALF OF: McDonald's Restaurants Ltd
DRAWING TITLE: Site Layout Plan As Proposed

DRAWN BY: BV
SCALE & SIZE: 1:200@A1

DESIGNED BY: JK
DATE: April 2022

DRAWING No.: 8342-SA-8333-P004 B



© Copyright McDonald's Restaurants & Scurr Architects

PHOENIX RD

BUMPSTEAD ROAD

