

NOTES

- THIS DRAWING IS TO BE READ IN CONJUNCTION WITH ALL RELEVANT ENGINEERS, ARCHITECTS AND SPECIALISTS DRAWINGS AND THE SPECIFICATION.
- DO NOT SCALE FROM THIS DRAWING MANUALLY OR ELECTRONICALLY. WRITTEN PERMISSION MUST BE OBTAINED FROM MLM PRIOR TO SCALING ELECTRONICALLY OR USING THIS ELECTRONIC FILE.

CONSTRUCTION (DESIGN AND MANAGEMENT) REGULATIONS 2015

DESIGNERS HAZARD INFORMATION FOR CONSTRUCTION

1. IF YOU DO NOT FULLY UNDERSTAND THE RISKS INVOLVED DURING THE CONSTRUCTION OF THE ITEMS INDICATED ON THIS DRAWING ASK YOUR MANAGER, HEALTH & SAFETY ADVISOR OR A MEMBER OF THE DESIGN TEAM BEFORE PROCEEDING.

THE ABOVE NOTES REFER SPECIFICALLY TO THE INFORMATION SHOWN ON THIS DRAWING.
REFER TO THE HEALTH AND SAFETY PLAN FOR FURTHER INFORMATION.

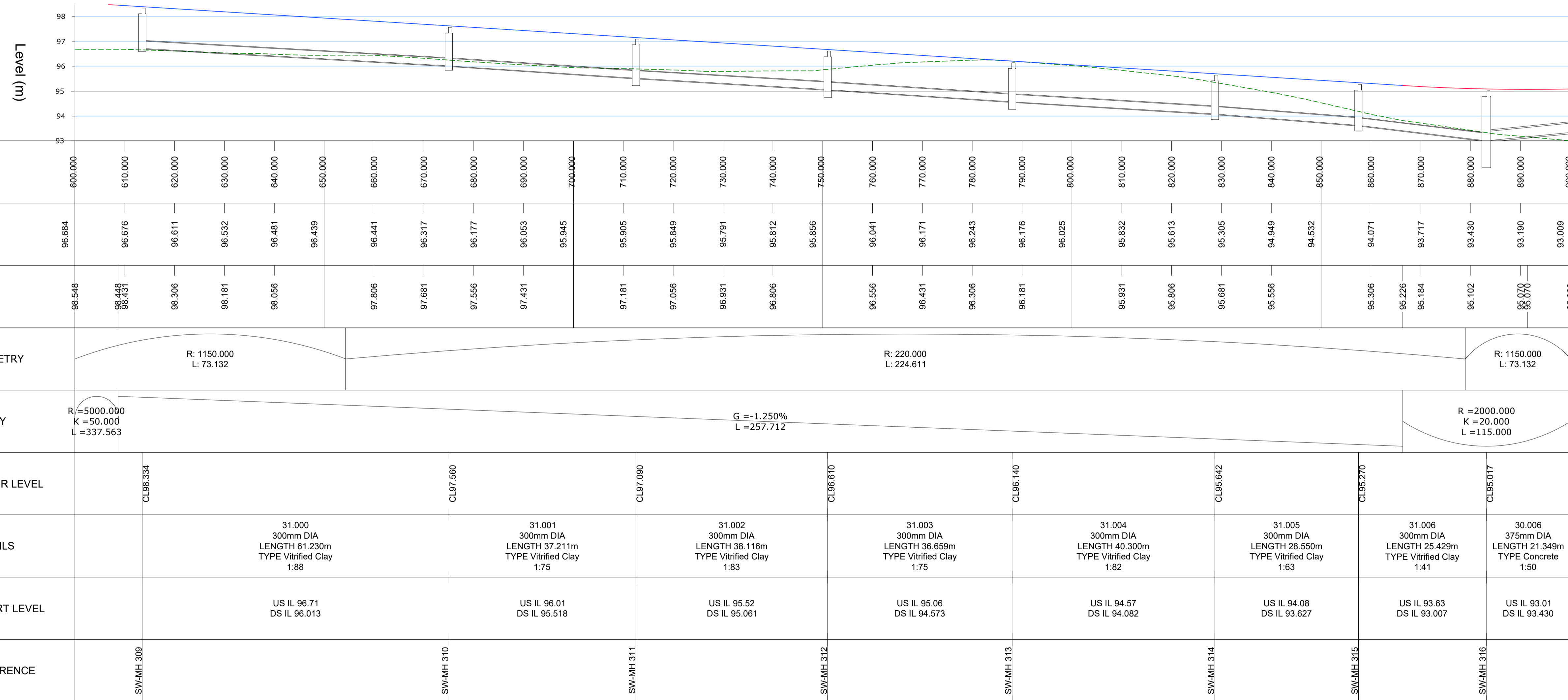

RELIEF ROAD - LONGSECTION (CH 600-900)
SCALE: H 1:500,V 1:100. DATUM: 93.009

REV	DATE	REVISION	MADE	CHK	APP
T02	07.11.2019	DRAINAGE ADDED ONTO LONG SECTIONS	DS	DK	DK
T01	06.09.2019	STATUS AMENDED	DS	DK	DK
P02	16.01.2019	REVISED TO REFLECT VERTICAL ALIGNMENT AMENDMENTS	LB	RA	RA
P01	08.02.2018	FIRST ISSUE	LB	DK	DK

TENDER

SUITABILITY DESCRIPTION
SUITABLE FOR INFORMATION

MLM Group
Part of Sweco

Connect 38,
1 Dover Place, Ashford,
Kent, TN23 1FB
Tel: 01233 610530
Website: www.mlmgroup.com

CLIENT

PROJECT
NORTHWEST HAVERHILL RELIEF ROAD

DRAWING TITLE
PROPOSED LONG-SECTIONS SHEET 3 OF 6

DRAWN/DESIGN	LB	MLM REF	STATUS	REVISION
SCALE	1:500 @A1	619132	S2	T02
PROJECT	ORIGINATOR	VOLUME/ SYSTEM/ LOCATIONS	LEVELS & TYPE	ROLE NUMBER
619132- MLM - ZZ - XX -DR- C -0023				

