

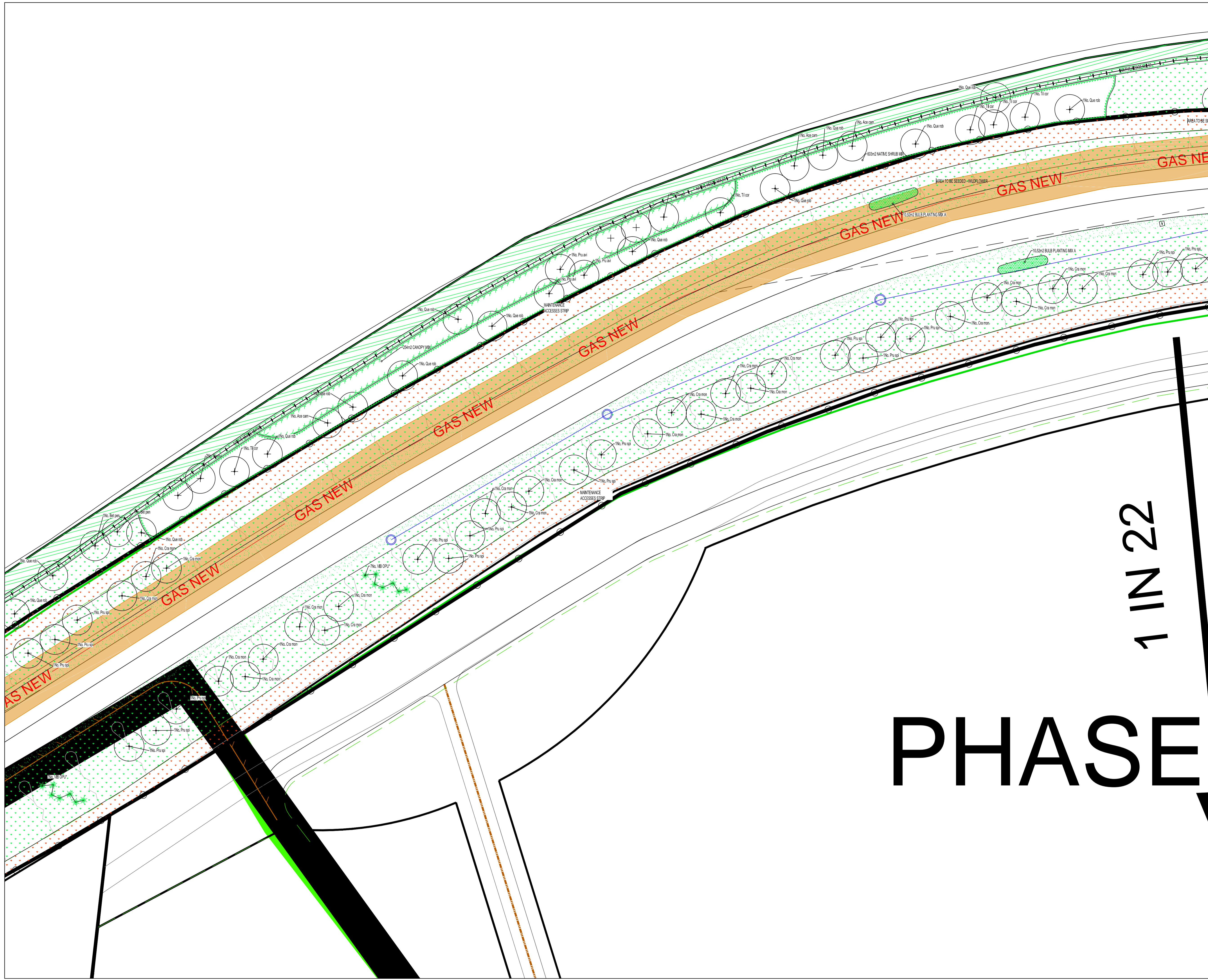

# KEY

- SOFT WORKS**
- PROPOSED FEATHERED TREE, INCLUDING STAKE BIODEGRADABLE SPIRAL AND TIE. SEE SPECIFICATION NOTES A1, B2-3, B5, C1-4, D1-2 AND E1.
  - PROPOSED STANDARD TREE, INCLUDING DOUBLE STAKE AND TIE. SEE SPECIFICATION NOTES A1, B2-3, B5, C1-4, D1-2 AND E1.
  - PROPOSED HEAVY STANDARD TREE, INCLUDING DOUBLE STAKE AND TIE. SEE SPECIFICATION NOTES A1, B2-3, B5, C1-4, D1-2 AND E1.
  - NATIVE WOODLAND WHIP AND SHRUB PLANTING IN MIXES, INCLUDING BIODEGRADABLE SHEET AND BARK MULCH (ACCORDING TO SPECIFICATION). REFER TO SPECIFICATION NOTES A1-2, B1-3, C1-3, D1-2 AND E1. WHERE LARGE AREAS OF PLANTING ARE PROPOSED, PLANTS SHOULD BE USED WITH RABBIT PROOF MESH FENCING/NETTING RATHER THAN INDIVIDUAL SHRUBS.
  - HEDGE PLANTING, INCLUDING BIODEGRADABLE SHEET AND BARK MULCH (ACCORDING TO SPECIFICATION). REFER TO HEDGE SCHEDULES ON PLAN AND THE SCHEDULE OF QUANTITIES. SEE SPECIFICATION NOTES A1-2, B1-3, B5, C1-3, D1-2 AND E1.
  - FLORAL LAWN SEEDED AREA. REFER TO PLANT SCHEDULE FOR SPECIFICATION OF MIX.
  - SSC HIGHWAYS VERGE MIX UNLESS OTHERWISE STATED ON PLAN. SEE SPECIFICATION NOTES B4, C5 AND E1.
  - WILDFLOWER MEADOW SEEDED AREA. REFER TO PLANT SCHEDULE FOR SPECIFICATION OF MIX.
  - WETLAND WILDFLOWER SEEDED AREA. REFER TO PLANT SCHEDULE FOR SPECIFICATION OF MIX.
  - MAINTENANCE ACCESS STRIP TO BE WILDFLOWER SEEDED AREA. REFER TO PLANT SCHEDULE FOR SPECIFICATION OF MIX.
  - RIBBED ROOT BARRIER REROOT 1000.
  - FOOTPATHS TO BE BITUMEN MACADAM, ALL DEPTHS TO ENGINEERS SPECIFICATION AND ALL TO HIGHWAYS AUTHORITY APPROVAL.
  - RELIEF ROAD DCON BOUNDARY - REFERENCE DCON(H)091283
  - EXISTING TREE TO BE RETAINED, SEE GENERAL NOTE A1 AND E1. IF PREPARED, SEE ALSO JAMES BLAKE ASSOCIATES PLAN AND SCHEDULE FOR ANY SURGERY WORKS.
  - EXISTING VEGETATION GROUP OR HEDGE TO BE RETAINED, SEE GENERAL NOTE A1 AND E1. IF PREPARED, SEE ALSO JAMES BLAKE ASSOCIATES PLAN AND SCHEDULE FOR ANY SURGERY WORKS.
  - AREA TO BE RETAINED GROUND FLORA
  - TREE PROTECTION FENCING - SEE JBA TREE PROTECTION PLANS FOR MORE DETAILS
  - NATIVE SPECIMEN SHRUBS IN GRASS, TO BE EITHER WHIPS OR CONTAINER GROWN. SPECIMEN SHRUBS IN GRASS ARE MEASURED SEPARATELY IN SCHEDULE OF QUANTITIES. SEE SPECIFICATION NOTES A1, B1-3, C1-3, D1-2 AND E1.
  - MARGINAL PLANTING. REFER TO PLANT SCHEDULE FOR SPECIFICATION OF MIX.
  - TUSOCK GRASSLAND. REFER TO PLANT SCHEDULE FOR SPECIFICATION OF MIX.
  - CALCAREOUS GRASSLAND. REFER TO PLANT SCHEDULE FOR SPECIFICATION OF MIX.
  - 32-STRAND WIRE AND TIMBER POST FENCE, TO BE ERRECTED THROUGH THE CENTRE OF THE STAGGERED ROW OF HEDGE.



# PHASE

1 IN 22

REV.	DATE	BY	CHKD.	DESCRIPTION
1	18.02.22	JBK	JBK	UPDATED TO NEW LAYOUT AND SOFT FINISHMENTS
2	22.02.22	JBK	JBK	UPDATED TO JBA COMMENTS AND NEW LAYOUT AND FINISHMENTS
3	22.02.22	JBK	JBK	UPDATED TO JBA COMMENTS AND NEW LAYOUT AND FINISHMENTS
4	01.03.22	JBK	JBK	UPDATED TO JBA COMMENTS AND NEW LAYOUT AND FINISHMENTS
5	01.03.22	JBK	JBK	UPDATED TO JBA COMMENTS AND NEW LAYOUT AND FINISHMENTS
6	11.03.22	JBK	JBK	UPDATED TO JBA COMMENTS AND NEW LAYOUT AND FINISHMENTS
7	24.03.22	JBK	JBK	UPDATED TO JBA COMMENTS AND NEW LAYOUT AND FINISHMENTS
8	13.03.22	JBK	JBK	UPDATED TO JBA COMMENTS AND NEW LAYOUT AND FINISHMENTS
9	13.03.22	JBK	JBK	UPDATED TO JBA COMMENTS AND NEW LAYOUT AND FINISHMENTS
10	08.03.22	JBK	JBK	UPDATED TO JBA COMMENTS AND NEW LAYOUT AND FINISHMENTS

CLIENT	FORBIMON HOMES SUFFOLK	DWG. TITLE	DETAILED SOFT LANDSCAPE PROPOSALS FOR INFRASTRUCTURE AREAS
SITE	HAVERHILL, RELIEF ROAD, HAVERHILL		
PURPOSE OF ISSUE	PLANNING		
DRG BY	JM	CHECKED	JBK
SCALE	1:250@A1	DATE	JANUARY 2018
DWG. NO.	JBAT1364 08	REV.	L

**JAMES BLAKE ASSOCIATES**

Head Office: 34-32 Old Westgate, Bury St Edmunds, Suffolk, IP33 3PA Tel: (01284) 335797  
 jamesblake@jamesblake.co.uk www.jamesblake.co.uk

LANDSCAPE ARCHITECTURE & AGRICULTURE & ECOLOGY