

GENERAL NOTES FOR THE DEVELOPER:

- Planting shall be set out clearly as shown on the drawings and measured from adjacent fixed points. Curved beds shall be set out using radii marked on the ground using two point stakes and a line between or with site marker paint. The junction between corner and straight runs shall be cut to a smooth and even finish. Check that all setting out conforms to the plan before cultivation and planting works are carried out. Failure to do so may result in rejection of the work by the landscape architect and may require amendment at the contractor's expense.
- All planting beds shall be a minimum of 1 metre wide, except where there is insufficient space, due to the constraints of walls and path edges and their boundaries. With narrow beds between walls and paths, ensure that the beds have a minimum width of 300mm from concrete footings before planting. If the soil is to be excavated, the contractor shall ensure that the soil is protected from concrete footings before planting. If the soil is to be excavated, the contractor shall ensure that the soil is protected from concrete footings before planting. If the soil is to be excavated, the contractor shall ensure that the soil is protected from concrete footings before planting.
- Plants shall be set out clearly as shown on the drawings and measured from adjacent fixed points. Curved beds shall be set out using radii marked on the ground using two point stakes and a line between or with site marker paint. The junction between corner and straight runs shall be cut to a smooth and even finish. Check that all setting out conforms to the plan before cultivation and planting works are carried out. Failure to do so may result in rejection of the work by the landscape architect and may require amendment at the contractor's expense.
- All planting beds shall be a minimum of 1 metre wide, except where there is insufficient space, due to the constraints of walls and path edges and their boundaries. With narrow beds between walls and paths, ensure that the beds have a minimum width of 300mm from concrete footings before planting. If the soil is to be excavated, the contractor shall ensure that the soil is protected from concrete footings before planting. If the soil is to be excavated, the contractor shall ensure that the soil is protected from concrete footings before planting.
- Plants shall be set out clearly as shown on the drawings and measured from adjacent fixed points. Curved beds shall be set out using radii marked on the ground using two point stakes and a line between or with site marker paint. The junction between corner and straight runs shall be cut to a smooth and even finish. Check that all setting out conforms to the plan before cultivation and planting works are carried out. Failure to do so may result in rejection of the work by the landscape architect and may require amendment at the contractor's expense.
- All planting beds shall be a minimum of 1 metre wide, except where there is insufficient space, due to the constraints of walls and path edges and their boundaries. With narrow beds between walls and paths, ensure that the beds have a minimum width of 300mm from concrete footings before planting. If the soil is to be excavated, the contractor shall ensure that the soil is protected from concrete footings before planting. If the soil is to be excavated, the contractor shall ensure that the soil is protected from concrete footings before planting.
- Plants shall be set out clearly as shown on the drawings and measured from adjacent fixed points. Curved beds shall be set out using radii marked on the ground using two point stakes and a line between or with site marker paint. The junction between corner and straight runs shall be cut to a smooth and even finish. Check that all setting out conforms to the plan before cultivation and planting works are carried out. Failure to do so may result in rejection of the work by the landscape architect and may require amendment at the contractor's expense.
- All planting beds shall be a minimum of 1 metre wide, except where there is insufficient space, due to the constraints of walls and path edges and their boundaries. With narrow beds between walls and paths, ensure that the beds have a minimum width of 300mm from concrete footings before planting. If the soil is to be excavated, the contractor shall ensure that the soil is protected from concrete footings before planting. If the soil is to be excavated, the contractor shall ensure that the soil is protected from concrete footings before planting.
- Plants shall be set out clearly as shown on the drawings and measured from adjacent fixed points. Curved beds shall be set out using radii marked on the ground using two point stakes and a line between or with site marker paint. The junction between corner and straight runs shall be cut to a smooth and even finish. Check that all setting out conforms to the plan before cultivation and planting works are carried out. Failure to do so may result in rejection of the work by the landscape architect and may require amendment at the contractor's expense.
- All planting beds shall be a minimum of 1 metre wide, except where there is insufficient space, due to the constraints of walls and path edges and their boundaries. With narrow beds between walls and paths, ensure that the beds have a minimum width of 300mm from concrete footings before planting. If the soil is to be excavated, the contractor shall ensure that the soil is protected from concrete footings before planting. If the soil is to be excavated, the contractor shall ensure that the soil is protected from concrete footings before planting.

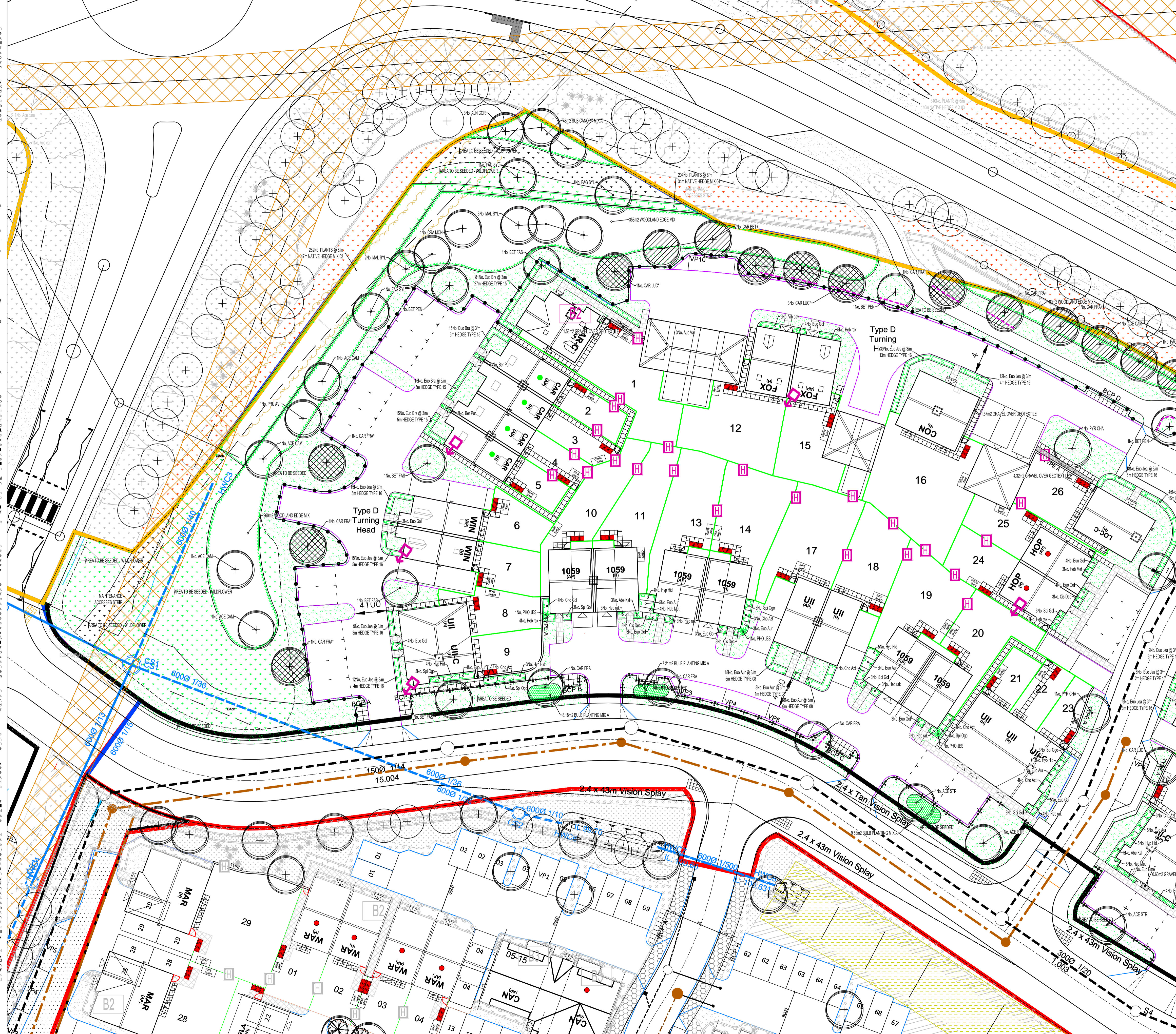

KEY

- PROPOSED STANDARD TREE, INCLUDING DOUBLE STAKE AND TIE. SEE SPECIFICATION NOTES A1, B2-3, B5, C1-4, D1-2 AND E1.
- PROPOSED HEAVY STANDARD TREE, INCLUDING DOUBLE STAKE AND TIE. SEE SPECIFICATION NOTES A1, B2-3, B5, C1-4, D1-2 AND E1.
- PROPOSED EXTRA HEAVY STANDARD TREE, INCLUDING DOUBLE STAKE AND TIE. SEE SPECIFICATION NOTES A1, B2-3, B5, C1-4, D1-2 AND E1.
- SHRUB AND HERBACEOUS PLANTING, INCLUDING BIODEGRADABLE SHEET AND BARK MULCH (ACCORDING TO SPECIFICATION). SEE SPECIFICATION NOTES A1-2, B1-3, C1-3, D1-2 AND E1.
- HEDGE PLANTING, INCLUDING BIODEGRADABLE SHEET AND BARK MULCH (ACCORDING TO SPECIFICATION). REFER TO HEDGE SCHEDULES ON PLAN AND THE SCHEDULE OF QUANTITIES. SEE SPECIFICATION NOTES A1-2, B1-3, C1-3, D1-2 AND E1.
- WASHED, ROUNDED, BUFF COLOURED GRAVEL, 20mm GAUGE, 40mm DEPTH, FINISHED LEVEL 15mm BELOW ADJACENT SURFACES Laid OVER 'COVERTEX' OVER LIGHTLY CONSOLIDATED SUBGRADE.
- CULTIVATED TURF UNLESS OTHERWISE STATED ON PLAN. SEE SPECIFICATION NOTES B4, C5 AND F10.
- BUILD PLANTING IN MIXES, SPRING FLOWERING VARIETIES. REFER TO SCHEDULE FOR FURTHER INFORMATION.
- SPECIMEN SHRUBS IN SHRUB BEDS OR PIT PLANTED IN GRASS GRAVEL AREAS. SPECIMEN SHRUBS IN GRASS ARE MEASURED SEPARATELY IN SCHEDULE OF QUANTITIES. SEE SPECIFICATION NOTES A1-1, B1-3, C1-3, D1-2 AND E1.
- EXISTING TREE TO BE RETAINED. SEE GENERAL NOTE A1 AND E1. SEE ALSO JAMES BLAKE ASSOCIATES PLAN AND SCHEDULE FOR ANY SURGICAL WORKS.
- EXISTING VEGETATION GROUP OR HEDGE TO BE RETAINED. SEE GENERAL NOTE A1 AND E1. SEE ALSO JAMES BLAKE ASSOCIATES PLAN AND SCHEDULE FOR ANY SURGICAL WORKS.
- SCHWEGLER 1SP HOUSE SPARROW TERRACE. AVAILABLE FROM NIBBS TEL: 01803 869913 OR SIMILAR AND APPROVED. INSTALLED UNDER EAVES FACING NORTH OR EAST, OR SIMILAR AND APPROVED.
- SCHWEGLER 1GS SWIFT BOX. AVAILABLE FROM NIBBS TEL: 01803 869913 OR SIMILAR AND APPROVED. INSTALLED UNDER EAVES FACING NORTH OR EAST, OR SIMILAR AND APPROVED.
- INTEGRATED EGOT BAT BOX. AVAILABLE FROM NIBBS TEL: 01803 869913 OR SIMILAR AND APPROVED. INSTALLED UNDER EAVES FACING NORTH OR EAST, OR SIMILAR AND APPROVED.
- PROPOSED HEDGE/BOX 15 x 15cm HOLES IN THE BASES OF FENCES AND WALLS OR GAPS UNDER GATES.
- 0.6M HIGH RAIL RAILING AS PER ARCHITECTS PROPOSALS.
- 1.05M HIGH ESTATE RAILING AS PER ARCHITECTS PROPOSALS.
- NATIVE WHIP AND SHRUB PLANTING IN MIXES, INCLUDING BIODEGRADABLE SHEET AND BARK MULCH (ACCORDING TO SPECIFICATION). SEE SPECIFICATION NOTES A1-2, B1-3, C1-3, D1-2 AND E1.
- WILDFLOWER MEADOW SEEDING AREA. REFER TO PLANT SCHEDULE FOR SPECIFICATION OF MIX.
- MAINTENANCE ACCESS STRIP TO BE WILDFLOWER SEEDING AREA. REFER TO PLANT SCHEDULE FOR SPECIFICATION OF MIX.
- ALLOW FOR RE-ROOT 2000 ROLL BARRIER. AVAILABLE FROM GREENBELT URBAN OR SIMILAR AND APPROVED. TO BE CONSTRUCTED TO MANUFACTURERS SPECIFICATIONS.

LANDSCAPE PROGRAMMING
 DUE TO NATIONAL PLANT SHORTAGE: PLANTS MAY TAKE UP TO 4 WEEKS TO BE DELIVERED. EARLY LEAD-IN FOR SOFT LANDSCAPE IS ESSENTIAL.

DATE: 14/07/2020	DR: JBA	REVISION: 01	DESCRIPTION: AMENDED TO REFLECT MANUFACTURER AND SUPPLIER INFORMATION
DATE: 14/07/2020	DR: JBA	REVISION: 02	DESCRIPTION: AMENDED TO REFLECT MANUFACTURER AND SUPPLIER INFORMATION
DATE: 14/07/2020	DR: JBA	REVISION: 03	DESCRIPTION: AMENDED TO REFLECT MANUFACTURER AND SUPPLIER INFORMATION
DATE: 14/07/2020	DR: JBA	REVISION: 04	DESCRIPTION: AMENDED TO REFLECT MANUFACTURER AND SUPPLIER INFORMATION

JAMES BLAKE ASSOCIATES

Head Office: 34-02 Oat Westgate, Bury St Edmunds, Suffolk, IP3 3PA Tel: (01284) 335787
 james.blake@jamesblake.co.uk

LANDSCAPE ARCHITECTURE • ARBORICULTURE • ECOLOGY