

SECTION A-A

Diameter of largest pipe in manhole/catchpit	Chamber Section dia (mm)
Less than 375mm	1200, reducing to 1050 where depth to soffit is between 1.35m and 1.5m
375 - 450	1350
500 - 700	1500
750 - 900	1800

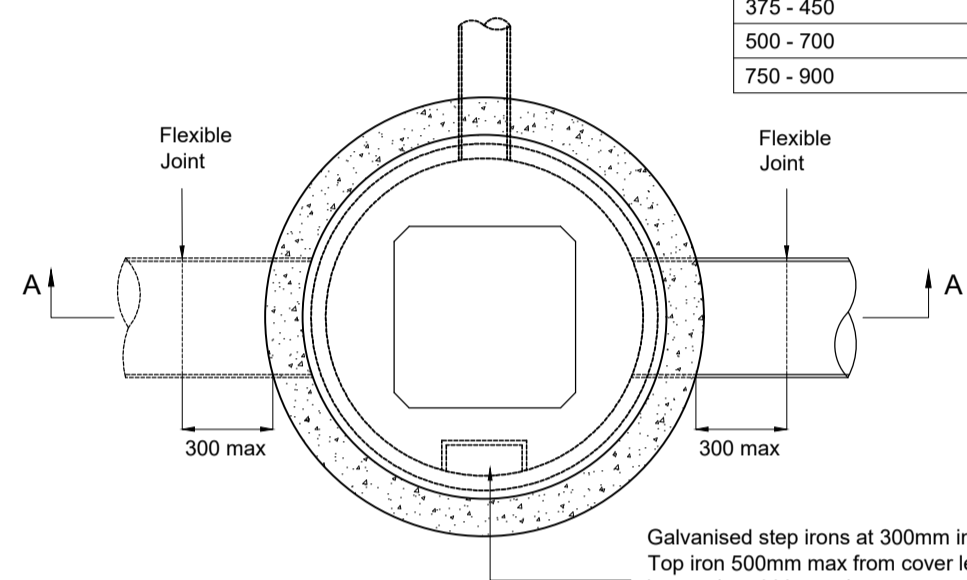

PLAN ON B-B

HIGHWAY CATCHPIT MANHOLE

- NOTES**
- All dimensions in millimetres.
 - Manhole cover or grating as detailed in specification.
 - Heavy duty precast cover slab placed with opening away from traffic wherever possible.
 - Where catchpits are constructed in the carriageway the top of the slab will be at formation level and the depth between the slab and frame will be constructed in engineering brickwork. Elsewhere up to 3 courses may be used.
 - Taper and shaft rings may be used provided bottom of taper is a minimum of 1.7m above concrete base.
 - Number of pipe openings to be as detailed in specification.
 - All carrier pipes shall have the same soffit level unless detailed otherwise in specification.
 - A minimum clear opening in cover to be: rectangular - 700mm across the diagonal, circular - 700mm diameter, triangular - 700mm diameter. See also SCC drawing 7/101

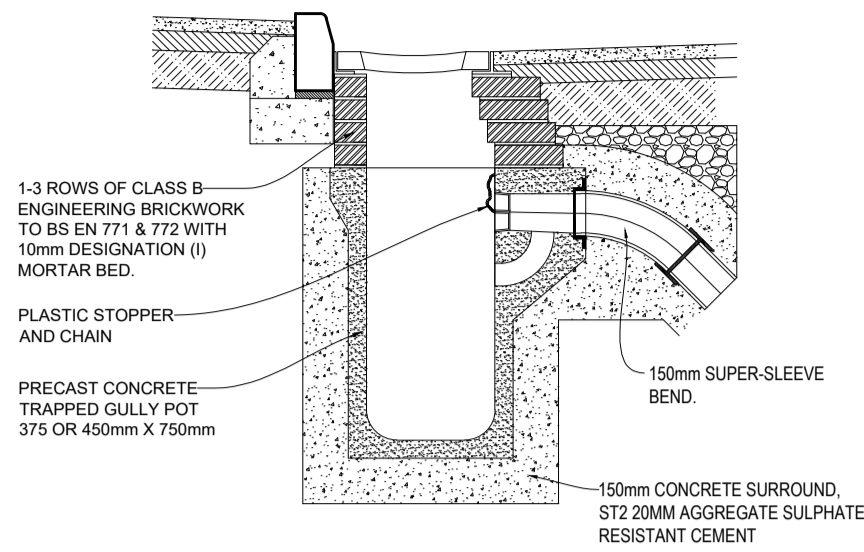

DRAINAGE - TRAPPED CARRIAGEWAY GULLY

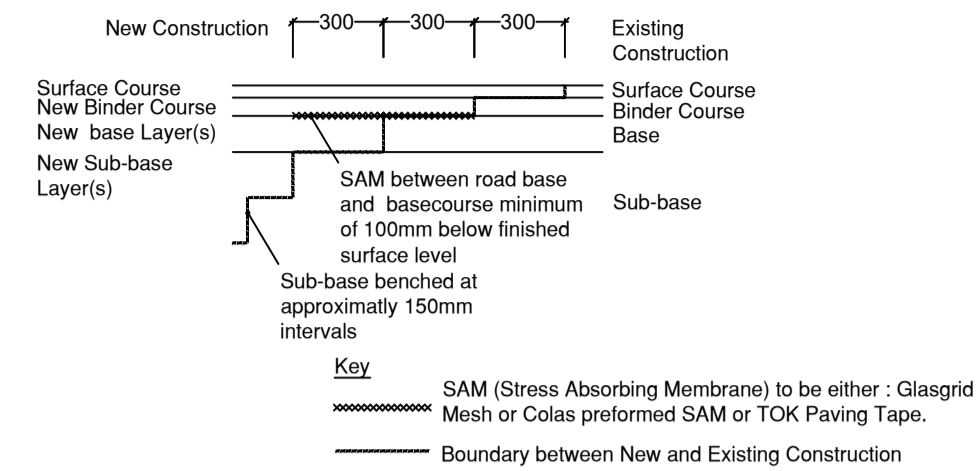

STEPPED CONSTRUCTION DETAIL (DIAGRAMMATIC)

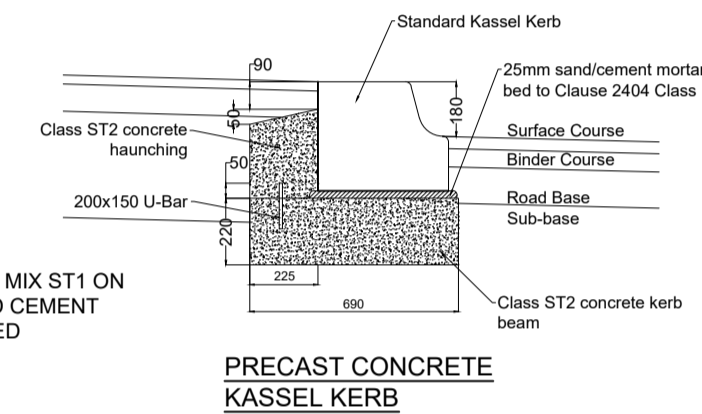
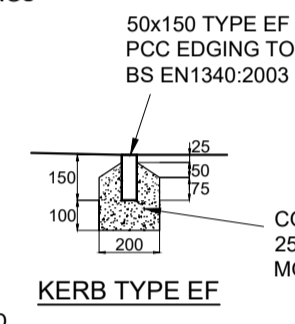
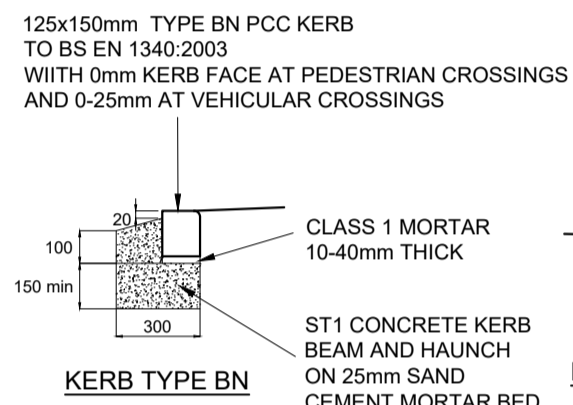
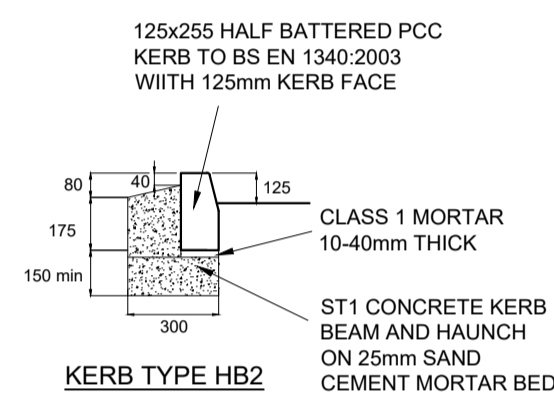

KERB DETAILS

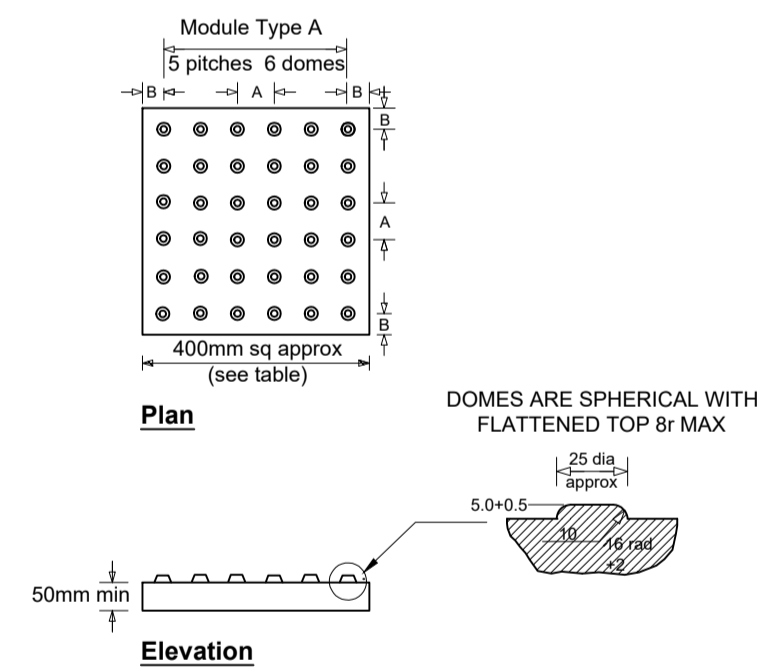

Module Type	Size (mm)	Pitch dimension (mm)	
		A	B
A	400sq	66.8	33
tolerance 2±			

THE ACTUAL DEPTH WILL BE RELATED TO THE MATERIALS USED TO CONSTRUCT THE MODULES

- NOTES**
- ALL DIMENSIONS IN MILLIMETERS.
 - RED PAVING TO BE USED AT CONTROLLED CROSSINGS, BUFF OR CONTRASTING COLOUR OTHER THAN RED TO BE USED AT UNCONTROLLED CROSSINGS.
 - CHANNELS TO BE LAID WITH 6mm UPSTAND.
 - TACTILE PAVING TO BE LAID SUCH THAT THE DOMES ARE IN LINE WITH THE DIRECTION OF PEDESTRIAN TRAVEL.
 - FOR MORE DETAILS REFER TO S.C.C. DRAWING NO. SCC 112103E.

TACTILE PAVING LAYOUTS

Rev	Description	Date	Drawn	Checked
A	Details added from sheet 1	30.05.22	LAM	LAM

Drawing Approval Status:-

N/A Section 104 N Section 38 N/A Section 278

FOR TENDER

Project:
Haverhill, Boyton Place

Drawing Description:
Highway Construction Details Sheet 2

Client: **PERSIMMON**

Persimmon Homes (Suffolk)
Persimmon House
Orion Court, Orion Avenue
Great Blakenham
Suffolk IP6 0LW

Drawing Number:
E3838/781/A

Client Reference:

Scale:
NTS @ A1
NTS @ A3

Designed By: **TJW** Drawn By: **JMW** Checked By: **PMW**

Date: Date: Date:

01.04.21