

- NOTES**
- THE DRAWING IS TO BE USED IN CONNECTION WITH ALL RELEVANT TENDERS, AGREEMENTS AND SPECIFICATIONS AND THE PERMITS.
 - DO NOT SCALE FROM THIS DRAWING MANUALLY OR ELECTRONICALLY. DIMENSIONS MUST BE OBTAINED FROM THE DRAWING MANUALLY OR ELECTRONICALLY.
 - PRELIMINARY DESIGN ONLY.
 - SCALE 1:200 HORIZONTALLY
 - SCALE 1:10 VERTICALLY
 - 1 IN 3 STOPS (CUT AND FILL) TO EXISTING GROUND PROFILE
 - 3.0% SUPERELEVATION APPLIED THROUGHOUT / CURVES
 - SHOULDER 3.0% CAMBER APPLIED TO STRADDERS

REPRODUCED FROM SUPERMAN DATA BY PERMISSION OF
 MASSIVE'S STATIONERY OFFICE © 2009, COPYRIGHT 2009
 LICENCE NUMBER AL10020449

CONSTRUCTION (DESIGN AND MANAGEMENT)
 REGULATIONS 2007
 DESIGNERS HAZARD INFORMATION FOR
 CONSTRUCTION

1. LOCATION AND CLEARANCE OF OVERHEAD ELECTRICITY CABLES TO BE CONFIRMED TO
 COMPLY WITH RELEVANT ELECTRICITY SUPPLIERS REQUIREMENTS.

THE ABOVE NOTES REFER SPECIFICALLY TO THE INFORMATION SHOWN ON THIS DRAWING.
 REFER TO THE HEALTH AND SAFETY PLAN FOR FURTHER INFORMATION.

FOR APPROVAL

Rev	Date	Description	Prepared	Checked
P1	01/02/09	FOR APPROVAL	GP	ASB

MIM
 Consulting Civil, Structural & Building Services Engineers
 25, London Road, Ipswich, Suffolk IP1 3JF
 Tel: 01473 231100 Fax: 01473 231515
 Website: www.mimuk.com
 Bedford • Cambridge • Chelmsford • London • Norwich

BIDWELLS PROPERTY CONSULTANTS
 TRUMPINGTON
 CAMBRIDGE CB2 9LD

Haverhill
 NORTH - WEST RELIEF ROAD

PROPOSED HIGHWAY ALIGNMENT
 PLAN AND LONG SECTION.
 (BASED ON A 85KPH DESIGN SPEED
 WITH DEPARTURES)

Drawing Title: 612263/71
 Date: 06/02/2009
 Scale: 1:200 HORIZONTALLY, 1:10 VERTICALLY
 All Rights Reserved

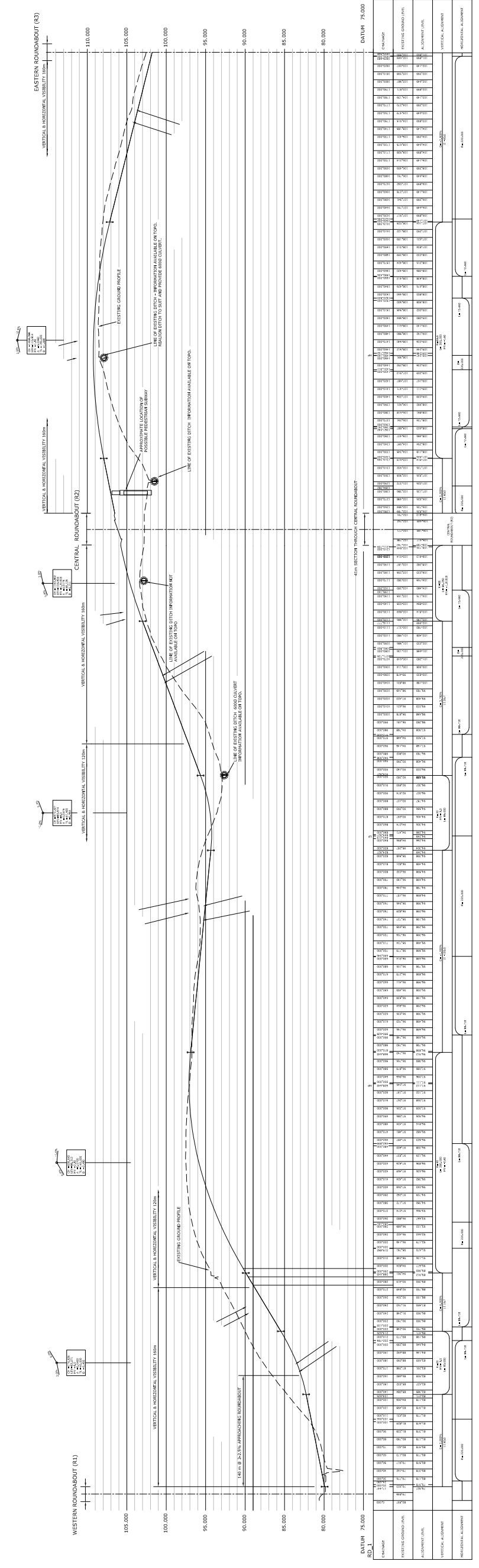

Haverhill, North - West Relief Road, 85KPH Design Speed, Alignment Long Section

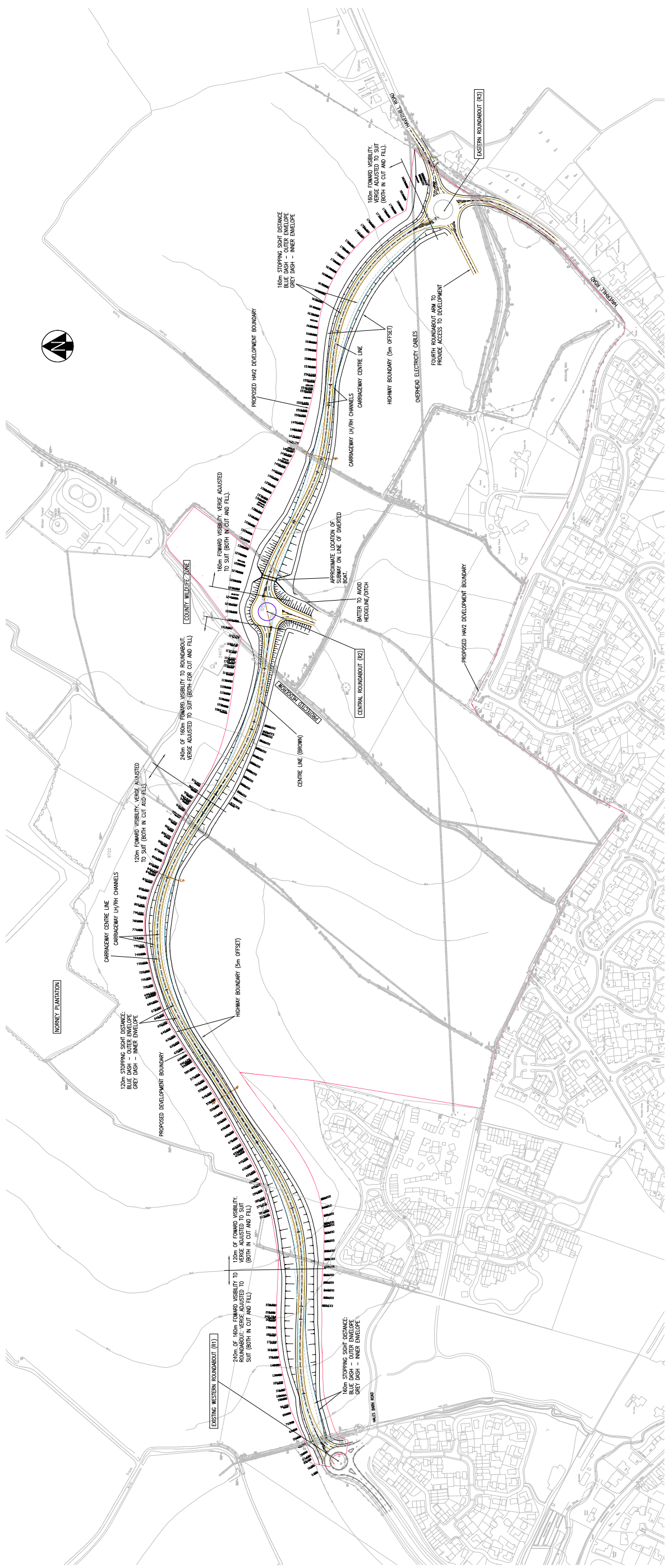

Haverhill, North - West Relief Road, 85KPH Design Speed, Horizontal Alignment