

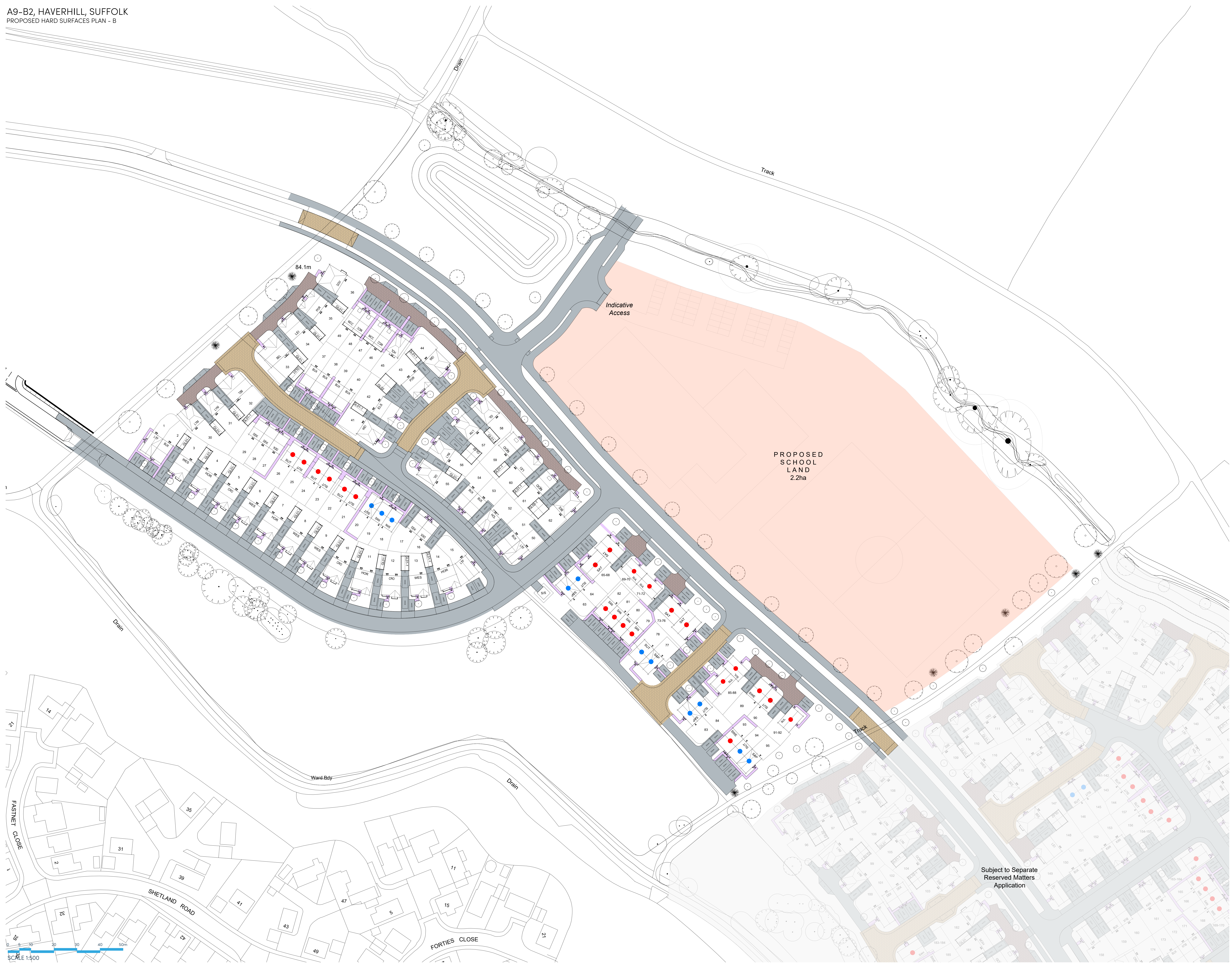

- PROPOSED SCHOOL LAND
(2.2 Ha)
- AFFORDABLE RENT UNITS
- SHARED OWNERSHIP UNITS
- INDICATIVE TREE LOCATION

Legend

- Macadam
- Brindle Block Paving
- Burnt Oak Block Paving
- Hoggin Path
- Private Front Footpaths
(Patio Slabs)



D	03.11.25	R&M modification	YC
C	29.10.25	Surface materials adjusted.	YC
B	18.10.25	Driveway surfaces included	DSG
A	14.08.25	The Plan updated to suit new layout Rev M	YC
Rev	Date	Amendment	Initials

Project:
A9-B2, HAVERHILL
SUFFOLK
Client:
BLOOR HOMES (EASTERN)
Drawing:
PROPOSED HARD SURFACES PLAN B

Drawing no: 24.2068A9-B2.2151
Scale@A1: 1:500 Date: JUNE 2025 Drawn: DC Checked: YC

finc Architects Ltd
61-63 New London Road | Chatteris | Cambs | CB4 9AD
T: +44 (0)1346 933889
W: www.fincharchitects.com
E: enquiry@fincharchitects.com

© FINEC Architects Limited holds the copyright to all the information contained within this document and that written consent must be obtained before copying or using the data other than for the purpose it was originally supplied.
All dimensions and measurements to be checked on site.
Do not scale from this drawing. This drawing is to be printed in colour.

PLANNING

Subject to Separate
Reserved Matters
Application