

SAFETY, HEALTH AND ENVIRONMENTAL INFORMATION

Significant risks relating to the works of which this design relates are identified below:

Identified significant risks:

This drawing is to be used only for the purpose of the issue it was intended for.

For information relating to end use, maintenance, demolition, see Health & Safety files.

It is assumed that works will be undertaken by a competent Contractor to an approved method statement.

Legend / Notes

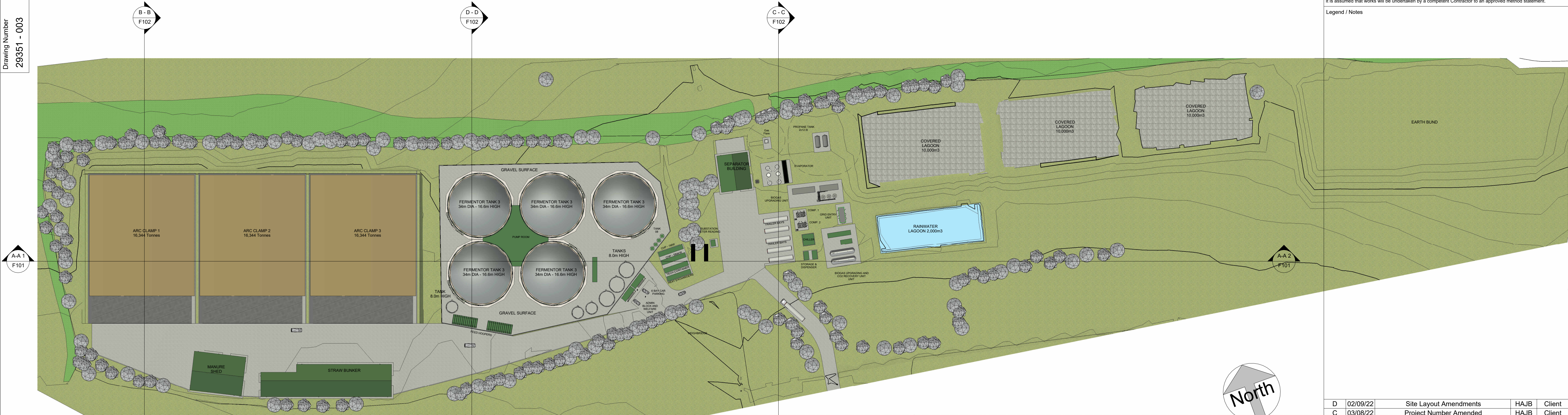

Block Plan
1 : 1000

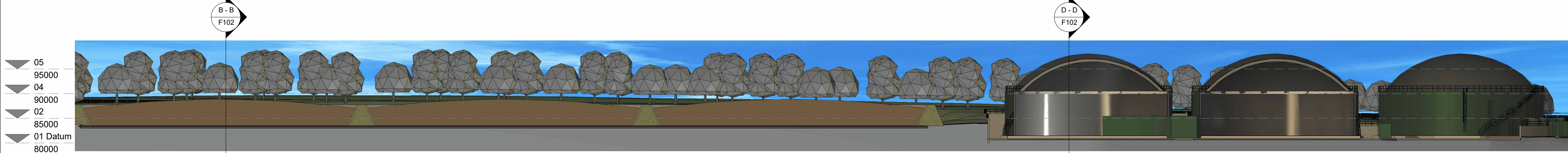

Section A - A - Part 1
1 : 500



Section A - A - Part 2
1 : 500



D	02/09/22	Site Layout Amendments	HAJB	Client
C	03/08/22	Project Number Amended	HAJB	Client
B	27/05/22	Minor Amendments	HAJB	Client
A	25/05/22	Client Amendments	HAJB	Client
Rev	Date	Description	DR	CH
Status			Suitability	
Site Layout Amendments				



Project
AD Plant - Thurlow Estate

Drawing Title
Site Plan as Proposed

Designed	Designer	Signed	Date	02/09/22
Drawn	HAJB	Signed	Date	02/09/22
Checked	Checker	Signed	Date	02/09/22
Approved	Approver	Signed	Date	02/09/22
Scale(s)		As indicated @A1		
Alternative Reference			Sheet	of
Drawing Number			Revision	
29351 - 003			F101	D