

Diagram illustrating the experimental setup for measuring the wavelength of light using a double-slit interference experiment. The setup includes a light source, a single slit, two slits, a lens, and a screen. The light source emits a beam that passes through a single slit, then splits into two paths through two slits. The paths recombine and pass through a lens to form an interference pattern on a screen. Labels include "Inside" for the slits and "Centre Stop" for the central barrier.

Technical drawing of a bridge deck cross-section. The drawing shows two 12m leaf widths, a central 250mm gap, and a total width of 2400mm. The drawing includes dimensions for concrete depth (750mm), road width, and various structural components like pre-cast concrete kerb units and reinforcement.

Key dimensions and components:

- Leaf Width: 12m (each side)
- Gap: 250mm
- Total Width: 2400mm
- Concrete Depth: 750mm
- Road Width: 1000mm (each side)
- Pre-Cast Concrete Kerb Unit: 125x225 Half Batter Type HB2
- Reinforcement: 125mm spacing
- Refer to Dwg No. 120 - Paving Plan For External Finishes
- 750x750x1000 Deep Concrete Grade S14 Pad Foundation

Scale 1:25

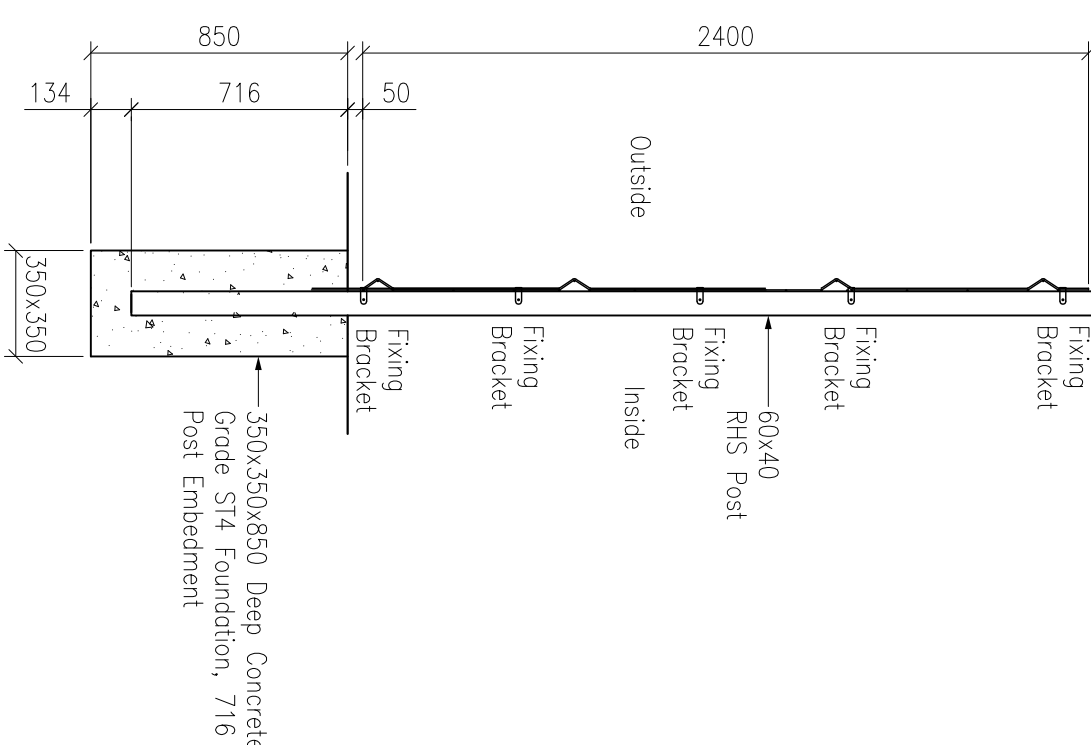
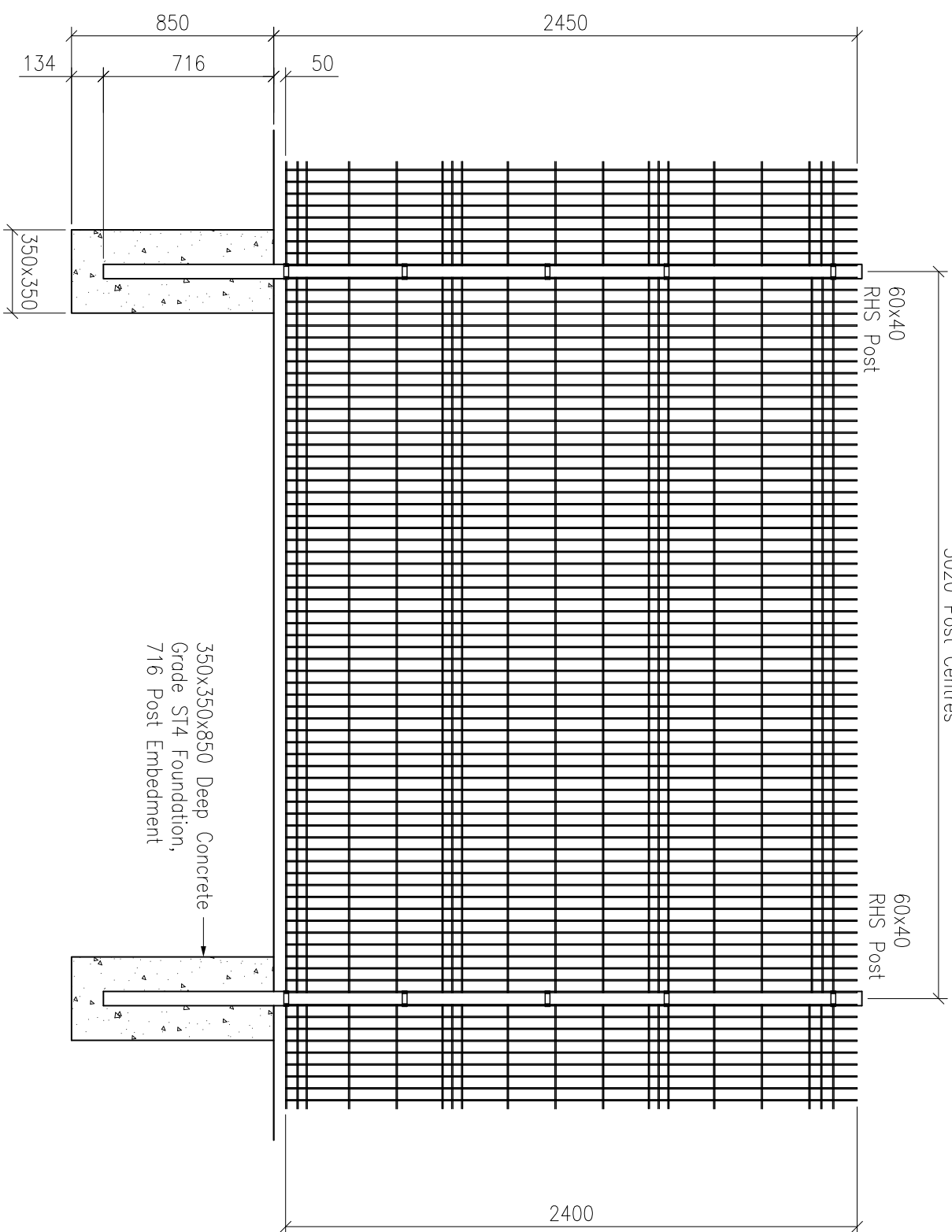
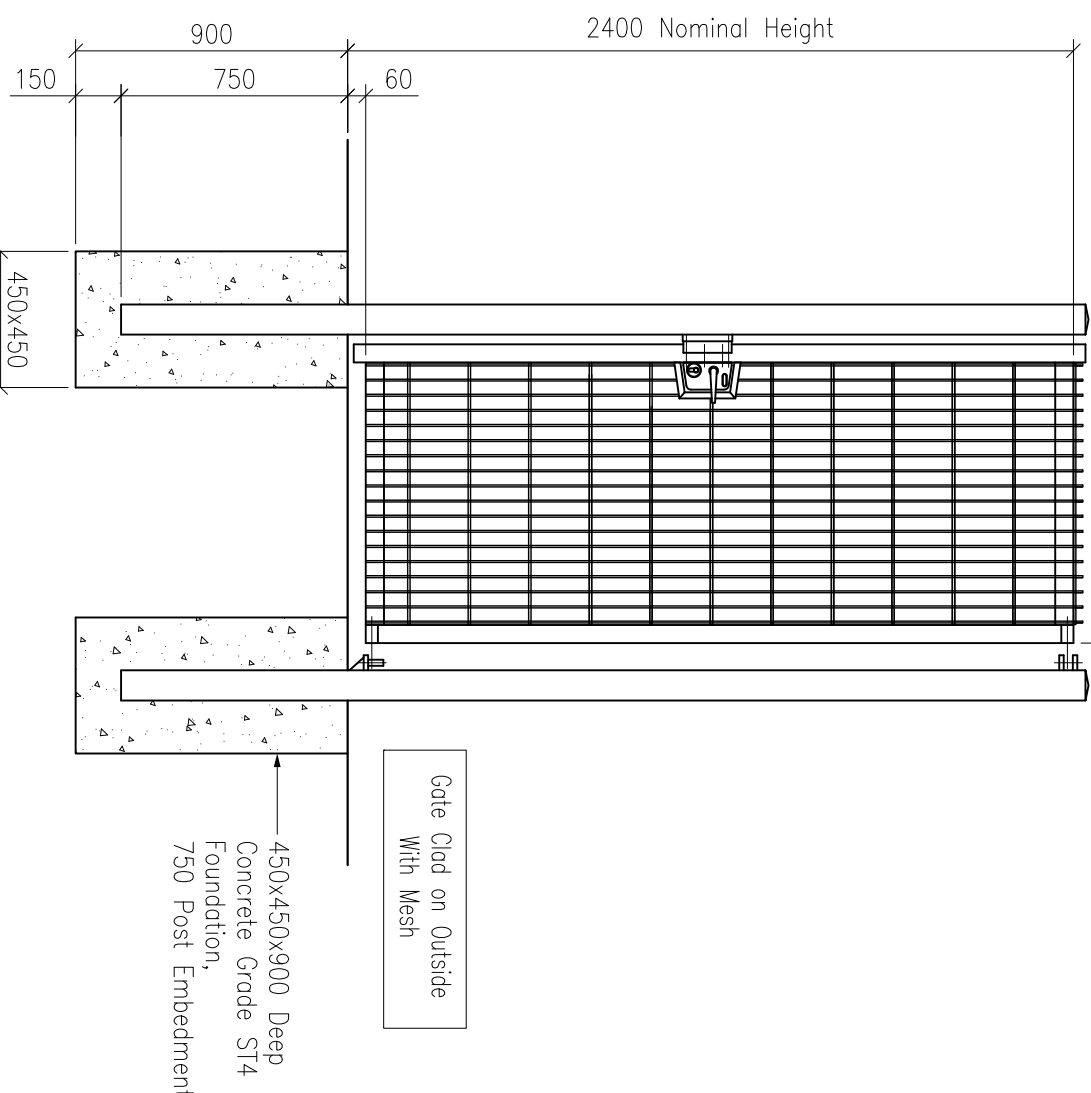
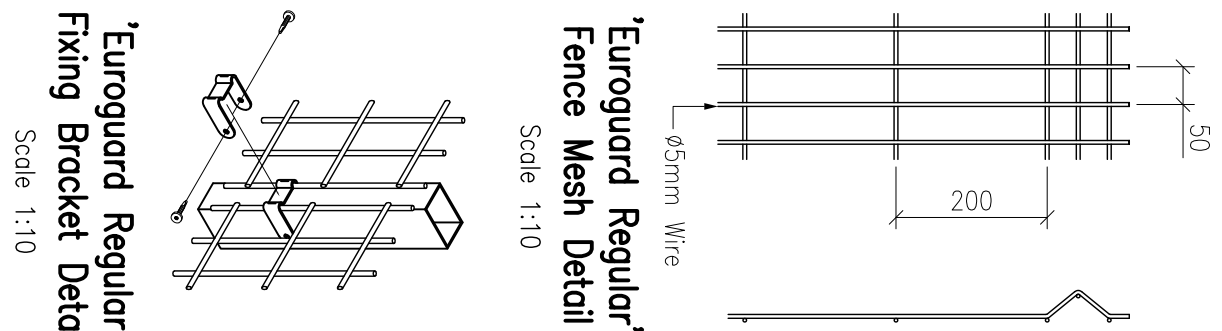
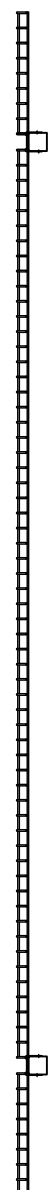
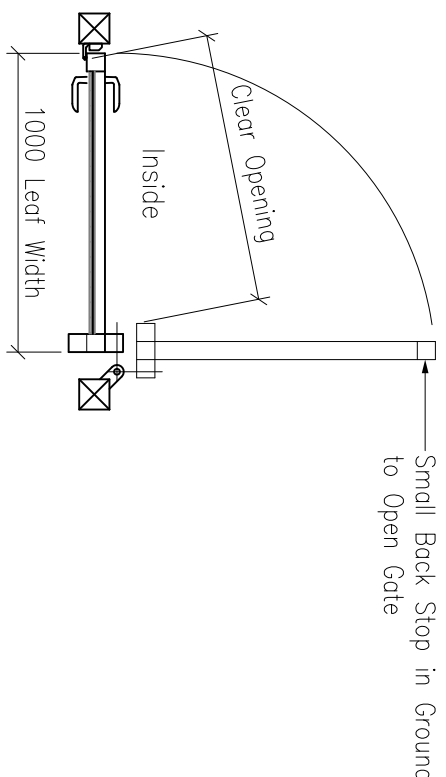

Scale 1:25

Scale 1:25

Dwg. No.	Rev
29351/P/2016	A